

# StoPanel<sup>®</sup> Systems

Detail Booklet

Series 51.xx | January 2024

Facades



StoPanel<sup>®</sup> systems provide a systemized approach to panelized construction offering many benefits over traditional pre-cast panels, including speed, value and superior performance. All panels are lightweight, energy efficient, durable and are available in a wide variety of aesthetic options. StoPanel systems are the preferred choice for new construction and renovation projects.





# Detail Booklet



## Guide Details

StoPanel Backup .....	3
StoPanel Classic NEXt ci .....	4
StoPanel Classic NEXt ci with StoCast Brick.....	6
StoPanel GPS ci .....	7
StoPanel MVES ci .....	9
StoPanel Dri-Design .....	11
StoPanel Metal ci .....	12
StoPanel Fiber Cement ci .....	13
StoPanel Impact LM ci .....	14
StoPanel Brick ci .....	16
StoPanel Precast ci .....	18
StoPanel 3DP .....	20
StoPanel Mineral ci .....	22
StoPanel Classic ci .....	25



### ATTENTION

The final design of any project is the sole responsibility of the Design Professional, with considerations for compliance of local building and design codes and requirements. Sto Corp. accepts no liability for design, engineering, or workmanship of any project. The information provided herein is in addition to other technical data provided by Sto Corp. (System Bulletin, Specification, Guide Details, etc). For more information, please visit [www.stocorp.com](http://www.stocorp.com)

**StoPanel**  
3800 Camp Creek Pkwy. SW  
Bldg. 1400 • Suite 120  
Atlanta, GA 30331  
Tel: (888) 227-8334 Ext. 40  
Fax: (856) 690-0100  
<http://www.stopanel.com>  
[helpdesk.stocorp.com](mailto:helpdesk.stocorp.com)

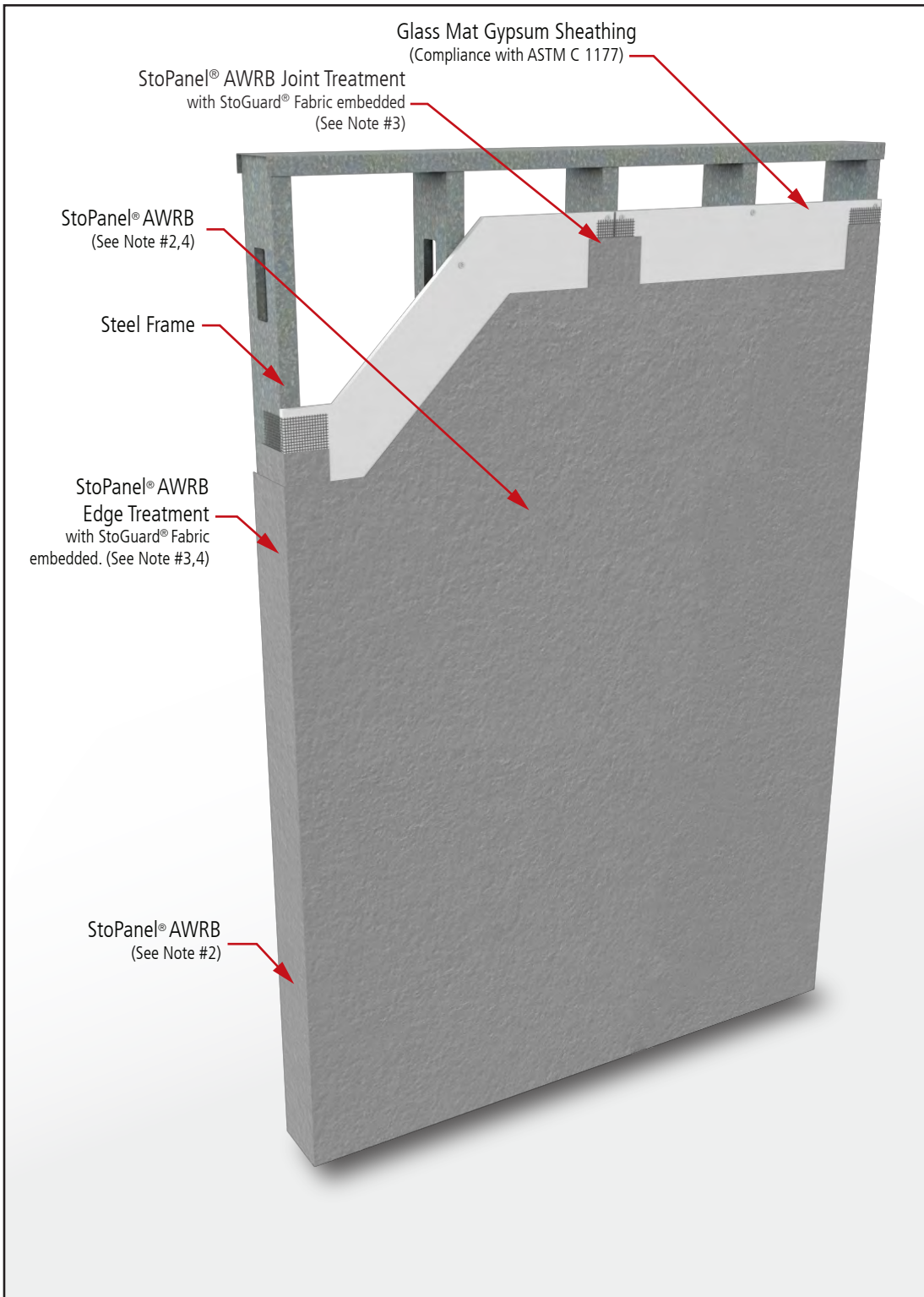

Detail No.: **51.70**  
 Date: **October 2023**  
 Page: **1 of 1**

**Notes:**

1. StoPanel® Backup is a lightweight, pre-fabricated exterior wall panel with continuous air and water-resistive barrier (AWRB).
2. Alternative air and water resistive barriers (AWRB): Sto Gold Coat®, Sto AirSeal®, and StoGuard® VaporSeal.
3. Alternative Edge and Joint Treatment: Sto RapidGuard®.
4. Protect StoPanel® AWRB with code compliant wall covering within 90 days or coat with StoColor® Acryl or StoColor® Acryl Plus for extended exposure (up to one year).
5. Components not identified as Sto are furnished by other manufacturers.

**ATTENTION**

Property of Sto Corp. All Rights Reserved.

Sto products are intended for use by qualified professional contractors, not consumers, as a component of a larger construction assembly as specified by a qualified design professional, general contractor or builder. They should be installed in accordance with those specifications and Sto's instructions. Sto Corp. disclaims all, and assumes no, liability for on-site inspections, for its products applied improperly, or by unqualified persons or entities, or as part of an improperly designed or constructed building, for the nonperformance of adjacent building components or assemblies, or for other construction activities beyond Sto's control. Improper use of Sto products or use as part of an improperly designed or constructed larger assembly or building may result in serious damage to Sto products, and to the structure of the building or its components.

STO CORP. DISCLAIMS ALL WARRANTIES EXPRESSED OR IMPLIED EXCEPT FOR EXPLICIT LIMITED WRITTEN WARRANTIES ISSUED TO AND ACCEPTED BY BUILDING OWNERS IN ACCORDANCE WITH STO'S WARRANTY PROGRAMS WHICH ARE SUBJECT TO CHANGE FROM TIME TO TIME. For the fullest, most current information on proper application, clean-up, mixing and other specifications and warranties, cautions and disclaimers, please refer to the Sto Corp. website, [www.stocorp.com](http://www.stocorp.com).

[www.stopanel.com](http://www.stopanel.com)



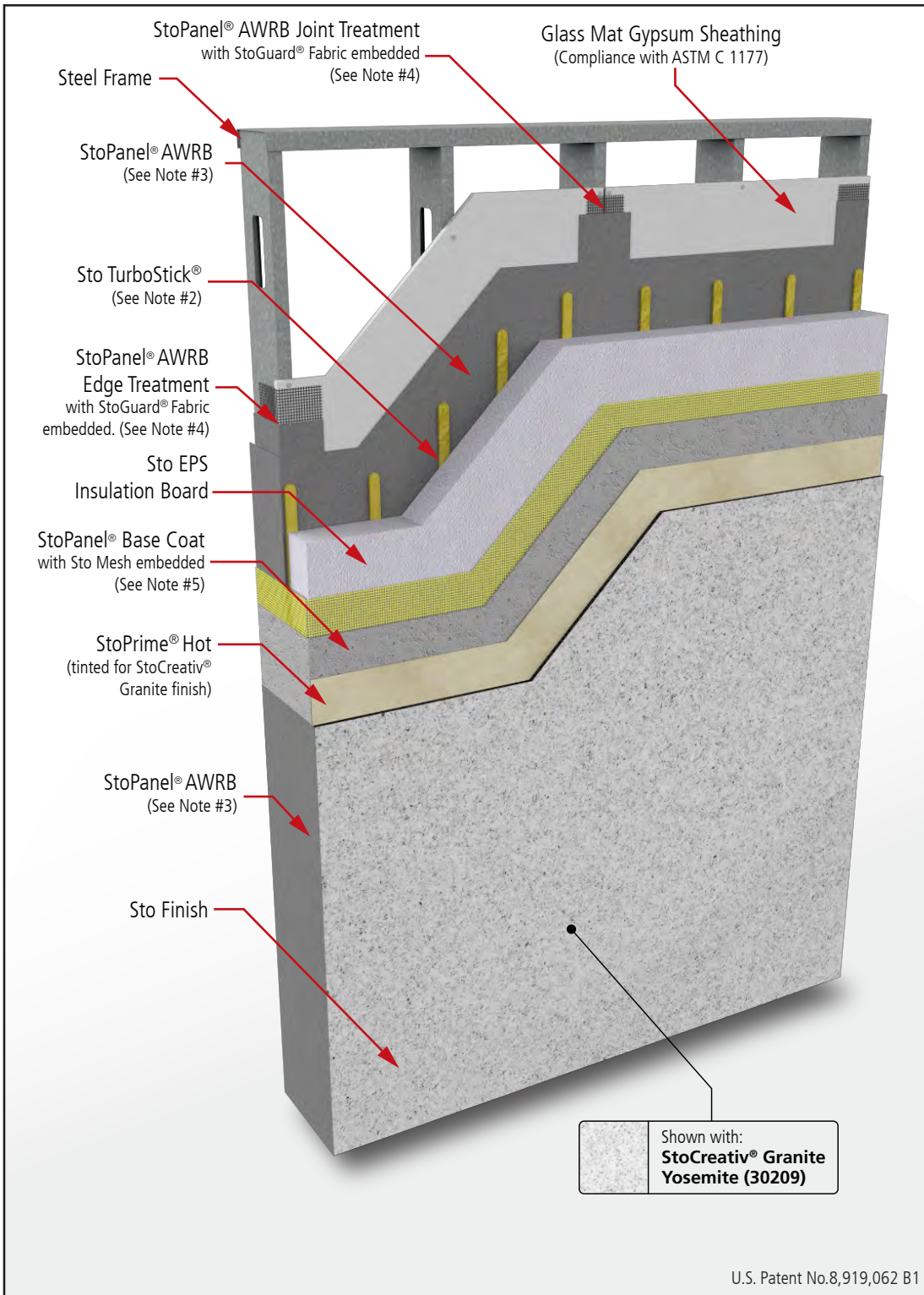

Detail No.: **51.01**  
 Date: **October 2023**  
 Page: **1 of 3**

**Notes:**

1. StoPanel® Classic NEXt ci is a lightweight energy efficient pre-fabricated exterior wall panel with continuous air and water-resistive barrier (AWRB). The panel can be finished with a wide variety of Sto textured finishes, Sto specialty finishes, and StoCast finishes.
2. Vertical ribbons of adhesive to provide channels for drainage. Alternative adhesives: Sto BTS® Plus, Sto Primer/Adhesive-B, Sto Primer/Adhesive (with their prescribed adhesive ribbon spacing).
3. Alternative air and water resistive barriers (AWRB): Sto Gold Coat®, Sto AirSeal®, and StoGuard® VaporSeal (requires Sto TurboStick™ Adhesive)
4. Alternative Edge and Joint Treatment: Sto RapidGuard®.
5. Alternative base coats: Sto BTS® Plus, Sto Primer/Adhesive-B, and Sto Primer/Adhesive (requires Sto textured finish).
6. Components not identified as Sto are furnished by other manufacturers.

**ATTENTION**

Sto products are intended for use by qualified professional contractors, not consumers, as a component of a larger construction assembly as specified by a qualified design professional, general contractor or builder. They should be installed in accordance with those specifications and Sto's instructions. Sto Corp. disclaims all, and assumes no, liability for on-site inspections, for its products applied improperly, or by unqualified persons or entities, or as part of an improperly designed or constructed building, for the nonperformance of adjacent building components or assemblies, or for other construction activities beyond Sto's control. Improper use of Sto products or use as part of an improperly designed or constructed larger assembly or building may result in serious damage to Sto products, and to the structure of the building or its components.

STO CORP. DISCLAIMS ALL WARRANTIES EXPRESSED OR IMPLIED EXCEPT FOR EXPLICIT LIMITED WRITTEN WARRANTIES ISSUED TO AND ACCEPTED BY BUILDING OWNERS IN ACCORDANCE WITH STO'S WARRANTY PROGRAMS WHICH ARE SUBJECT TO CHANGE FROM TIME TO TIME. For the fullest, most current information on proper application, clean-up, mixing and other specifications and warranties, cautions and disclaimers, please refer to the Sto Corp. website, [www.stocorp.com](http://www.stocorp.com).

Property of Sto Corp. All Rights Reserved.

[www.stopanel.com](http://www.stopanel.com)



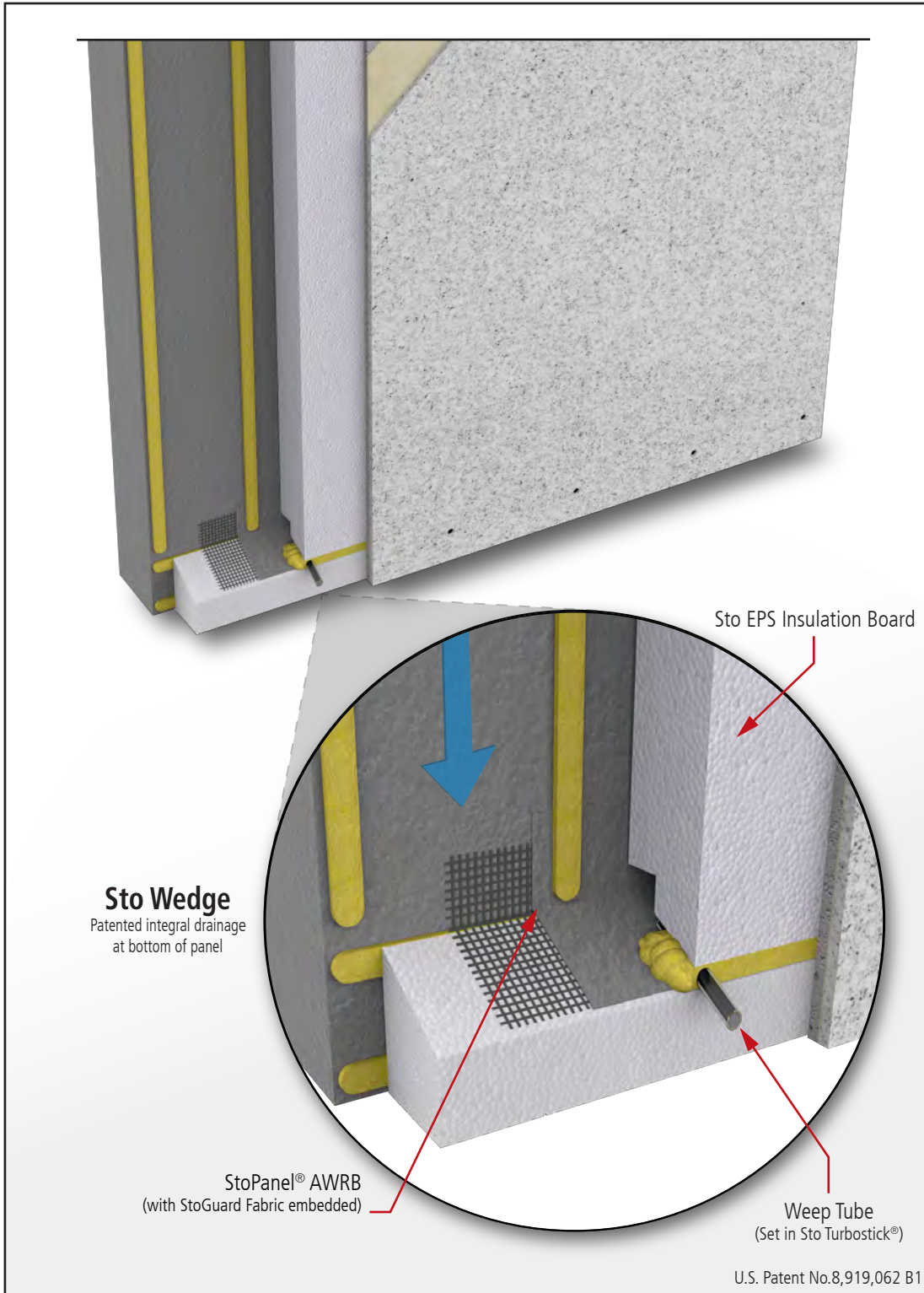

Detail No.: **51.01**  
 Date: **October 2023**  
 Page: **2 of 3**

**Notes:**

1. StoPanel® Classic NEXt ci is a lightweight energy efficient pre-fabricated exterior wall panel with continuous air and water-resistive barrier (AWRB). The panel can be finished with a wide variety of Sto textured finishes, Sto specialty finishes, and StoCast finishes.
2. Vertical ribbons of adhesive to provide channels for drainage. Alternative adhesives: Sto BTS® Plus, Sto Primer/Adhesive-B, Sto Primer/Adhesive (with their prescribed adhesive ribbon spacing).
3. Alternative air and water resistive barriers (AWRB): Sto Gold Coat®, Sto AirSeal®, and StoGuard® VaporSeal (requires Sto TurboStick™ Adhesive)
4. Alternative Edge and Joint Treatment: Sto RapidGuard®.
5. Alternative base coats: Sto BTS® Plus, Sto Primer/Adhesive-B, and Sto Primer/Adhesive (requires Sto textured finish).
6. Components not identified as Sto are furnished by other manufacturers.

**ATTENTION**

Property of Sto Corp. All Rights Reserved.

Sto products are intended for use by qualified professional contractors, not consumers, as a component of a larger construction assembly as specified by a qualified design professional, general contractor or builder. They should be installed in accordance with those specifications and Sto's instructions. Sto Corp. disclaims all, and assumes no, liability for on-site inspections, for its products applied improperly, or by unqualified persons or entities, or as part of an improperly designed or constructed building, for the nonperformance of adjacent building components or assemblies, of for other construction activities beyond Sto's control. Improper use of Sto products or use as part of an improperly designed or constructed larger assembly or building may result in serious damage to Sto products, and to the structure of the building or its components.

STO CORP. DISCLAIMS ALL WARRANTIES EXPRESSED OR IMPLIED EXCEPT FOR EXPLICIT LIMITED WRITTEN WARRANTIES ISSUED TO AND ACCEPTED BY BUILDING OWNERS IN ACCORDANCE WITH STO'S WARRANTY PROGRAMS WHICH ARE SUBJECT TO CHANGE FROM TIME TO TIME.  
 For the fullest, most current information on proper application, clean-up, mixing and other specifications and warranties, cautions and disclaimers, please refer to the Sto Corp. website, [www.stocorp.com](http://www.stocorp.com).

[www.stopanel.com](http://www.stopanel.com)



# StoPanel® Classic NEXt ci with StoCast Brick

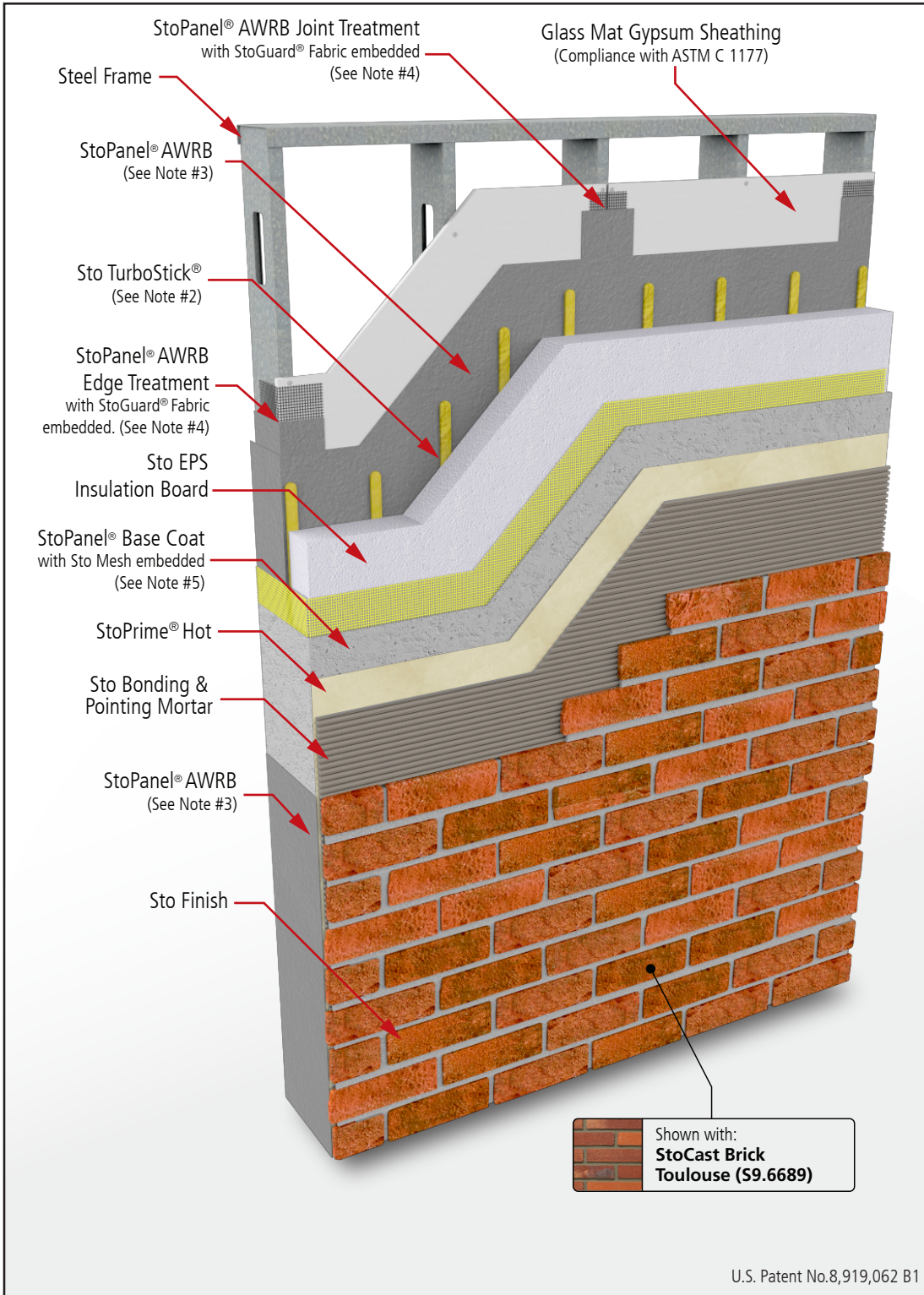

Detail No.: **51.01**  
Date: **April 2024**  
Page: **3 of 3**

### Notes:

1. StoPanel® Classic NEXt ci is a lightweight energy efficient pre-fabricated exterior wall panel with continuous air and water-resistive barrier (AWRB). The panel can be finished with a wide variety of Sto textured finishes, Sto specialty finishes, and StoCast finishes.
2. Vertical ribbons of adhesive to provide channels for drainage. Alternative adhesives: Sto BTS® Plus, Sto Primer/Adhesive-B, Sto Primer/Adhesive (with their prescribed adhesive ribbon spacing).
3. Alternative air and water resistive barriers (AWRB): Sto Gold Coat®, Sto AirSeal®, and StoGuard® VaporSeal (requires Sto TurboStick™ Adhesive)
4. Alternative Edge and Joint Treatment: Sto RapidGuard®.
5. Alternative base coats: Sto BTS® Plus, Sto Primer/Adhesive-B, and Sto Primer/Adhesive (requires Sto textured finish).
6. Components not identified as Sto are furnished by other manufacturers.

U.S. Patent No.8,919,062 B1

### ATTENTION

Property of Sto Corp. All Rights Reserved.

Sto products are intended for use by qualified professional contractors, not consumers, as a component of a larger construction assembly as specified by a qualified design professional, general contractor or builder. They should be installed in accordance with those specifications and Sto's instructions. Sto Corp. disclaims all, and assumes no, liability for on-site inspections, for its products applied improperly, or by unqualified persons or entities, or as part of an improperly designed or constructed building, for the nonperformance of adjacent building components or assemblies, or for other construction activities beyond Sto's control. Improper use of Sto products or use as part of an improperly designed or constructed larger assembly or building may result in serious damage to Sto products, and to the structure of the building or its components.

STO CORP. DISCLAIMS ALL WARRANTIES EXPRESSED OR IMPLIED EXCEPT FOR EXPLICIT LIMITED WRITTEN WARRANTIES ISSUED TO AND ACCEPTED BY BUILDING OWNERS IN ACCORDANCE WITH STO'S WARRANTY PROGRAMS WHICH ARE SUBJECT TO CHANGE FROM TIME TO TIME. For the fullest, most current information on proper application, clean-up, mixing and other specifications and warranties, cautions and disclaimers, please refer to the Sto Corp. website, [www.stocorp.com](http://www.stocorp.com).

[www.stopanel.com](http://www.stopanel.com)



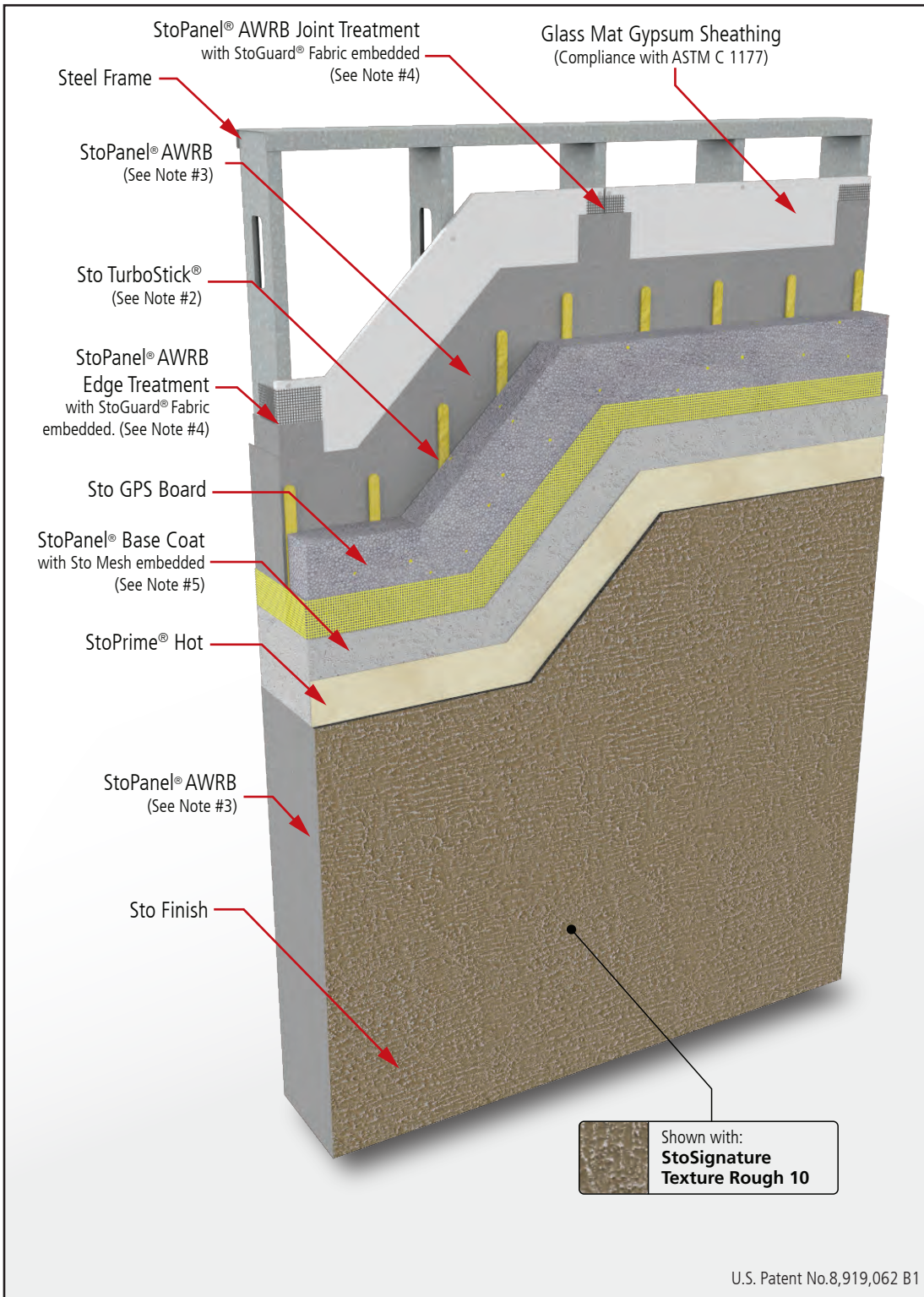

Detail No.: **51.03**  
 Date: **October 2023**  
 Page: **1 of 2**

**Notes:**

1. StoPanel® GPS ci is a lightweight energy efficient pre-fabricated exterior wall panel with graphite polystyrene (GPS) continuous insulation and a continuous air and water-resistive barrier (AWRB). The panel can be finished with a wide variety of Sto textured finishes, Sto specialty finishes, and StoCast finishes.
2. Vertical ribbons of adhesive to provide channels for drainage.
3. Alternative air and water resistive barriers (AWRB): Sto Gold Coat®, Sto AirSeal®, and StoGuard® VaporSeal (requires Sto TurboStick™ Adhesive)
4. Alternative Edge and Joint Treatment: Sto RapidGuard®.
5. Alternative base coats: Sto BTS® Plus, Sto Primer/Adhesive-B, and Sto Primer/Adhesive (requires Sto textured finish).
6. Components not identified as Sto are furnished by other manufacturers.

**ATTENTION**

Sto products are intended for use by qualified professional contractors, not consumers, as a component of a larger construction assembly as specified by a qualified design professional, general contractor or builder. They should be installed in accordance with those specifications and Sto's instructions. Sto Corp. disclaims all, and assumes no, liability for on-site inspections, for its products applied improperly, or by unqualified persons or entities, or as part of an improperly designed or constructed building, for the nonperformance of adjacent building components or assemblies, or for other construction activities beyond Sto's control. Improper use of Sto products or use as part of an improperly designed or constructed larger assembly or building may result in serious damage to Sto products, and to the structure of the building or its components.

STO CORP. DISCLAIMS ALL WARRANTIES EXPRESSED OR IMPLIED EXCEPT FOR EXPLICIT LIMITED WRITTEN WARRANTIES ISSUED TO AND ACCEPTED BY BUILDING OWNERS IN ACCORDANCE WITH STO'S WARRANTY PROGRAMS WHICH ARE SUBJECT TO CHANGE FROM TIME TO TIME. For the fullest, most current information on proper application, clean-up, mixing and other specifications and warranties, cautions and disclaimers, please refer to the Sto Corp. website, [www.stocorp.com](http://www.stocorp.com).

Property of Sto Corp. All Rights Reserved.

[www.stopanel.com](http://www.stopanel.com)



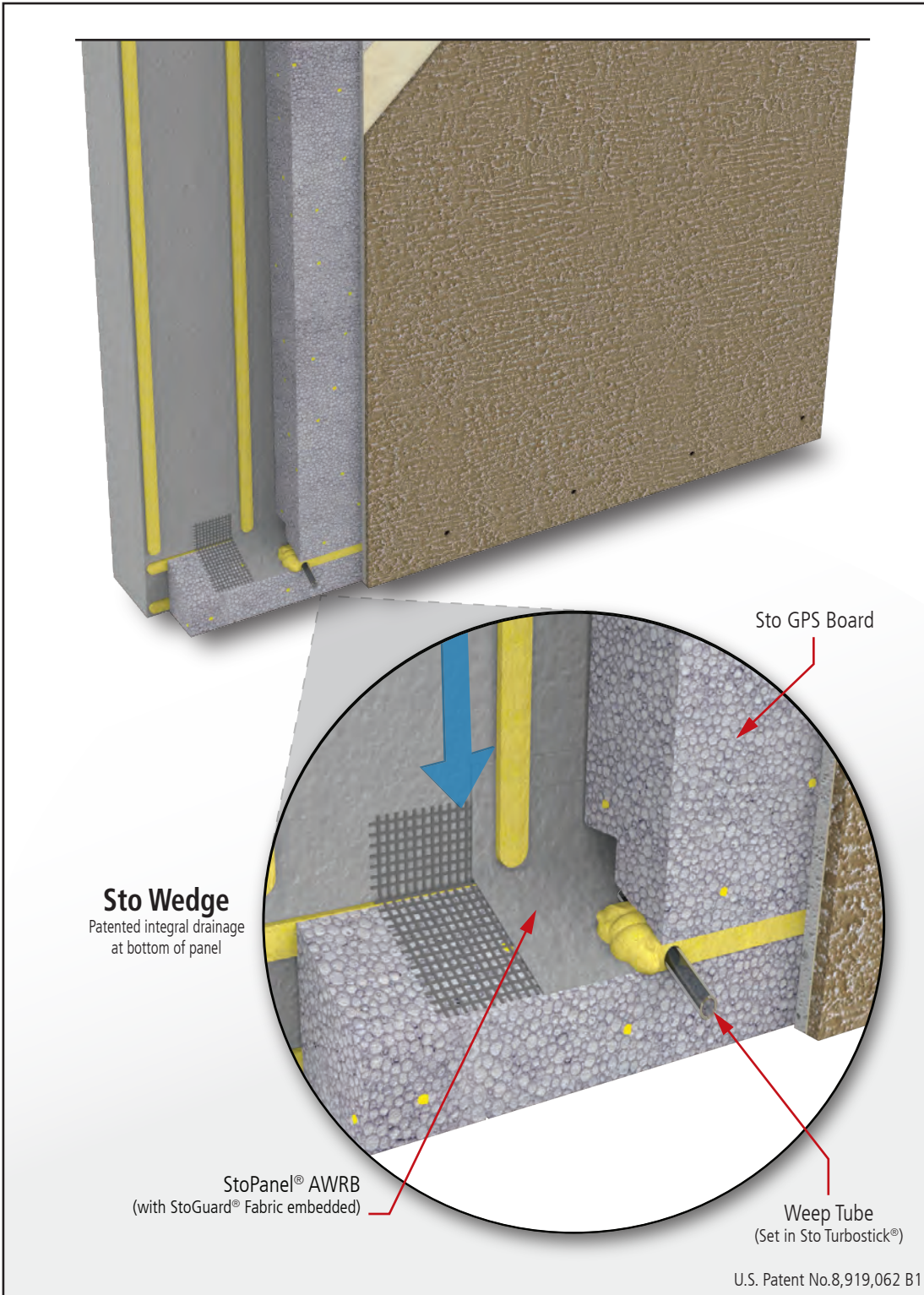

Detail No.: **51.03**  
Date: **October 2023**  
Page: **2 of 2**

**Notes:**

1. StoPanel® GPS ci is a lightweight energy efficient pre-fabricated exterior wall panel with graphite polystyrene (GPS) continuous insulation and a continuous air and water-resistive barrier (AWRB). The panel can be finished with a wide variety of Sto textured finishes, Sto specialty finishes, and StoCast finishes.
2. Vertical ribbons of adhesive to provide channels for drainage.
3. Alternative air and water resistive barriers (AWRB): Sto Gold Coat®, Sto AirSeal®, and StoGuard® VaporSeal (requires Sto TurboStick™ Adhesive)
4. Alternative Edge and Joint Treatment: Sto RapidGuard®.
5. Alternative base coats: Sto BTS® Plus, Sto Primer/Adhesive-B, and Sto Primer/Adhesive (requires Sto textured finish).
6. Components not identified as Sto are furnished by other manufacturers.

**ATTENTION**

Property of Sto Corp. All Rights Reserved.

Sto products are intended for use by qualified professional contractors, not consumers, as a component of a larger construction assembly as specified by a qualified design professional, general contractor or builder. They should be installed in accordance with those specifications and Sto's instructions. Sto Corp. disclaims all, and assumes no, liability for on-site inspections, for its products applied improperly, or by unqualified persons or entities, or as part of an improperly designed or constructed building, for the nonperformance of adjacent building components or assemblies, of for other construction activities beyond Sto's control. Improper use of Sto products or use as part of an improperly designed or constructed larger assembly or building may result in serious damage to Sto products, and to the structure of the building or its components.

STO CORP. DISCLAIMS ALL WARRANTIES EXPRESSED OR IMPLIED EXCEPT FOR EXPLICIT LIMITED WRITTEN WARRANTIES ISSUED TO AND ACCEPTED BY BUILDING OWNERS IN ACCORDANCE WITH STO'S WARRANTY PROGRAMS WHICH ARE SUBJECT TO CHANGE FROM TIME TO TIME. For the fullest, most current information on proper application, clean-up, mixing and other specifications and warranties, cautions and disclaimers, please refer to the Sto Corp. website, [www.stocorp.com](http://www.stocorp.com).

[www.stopanel.com](http://www.stopanel.com)





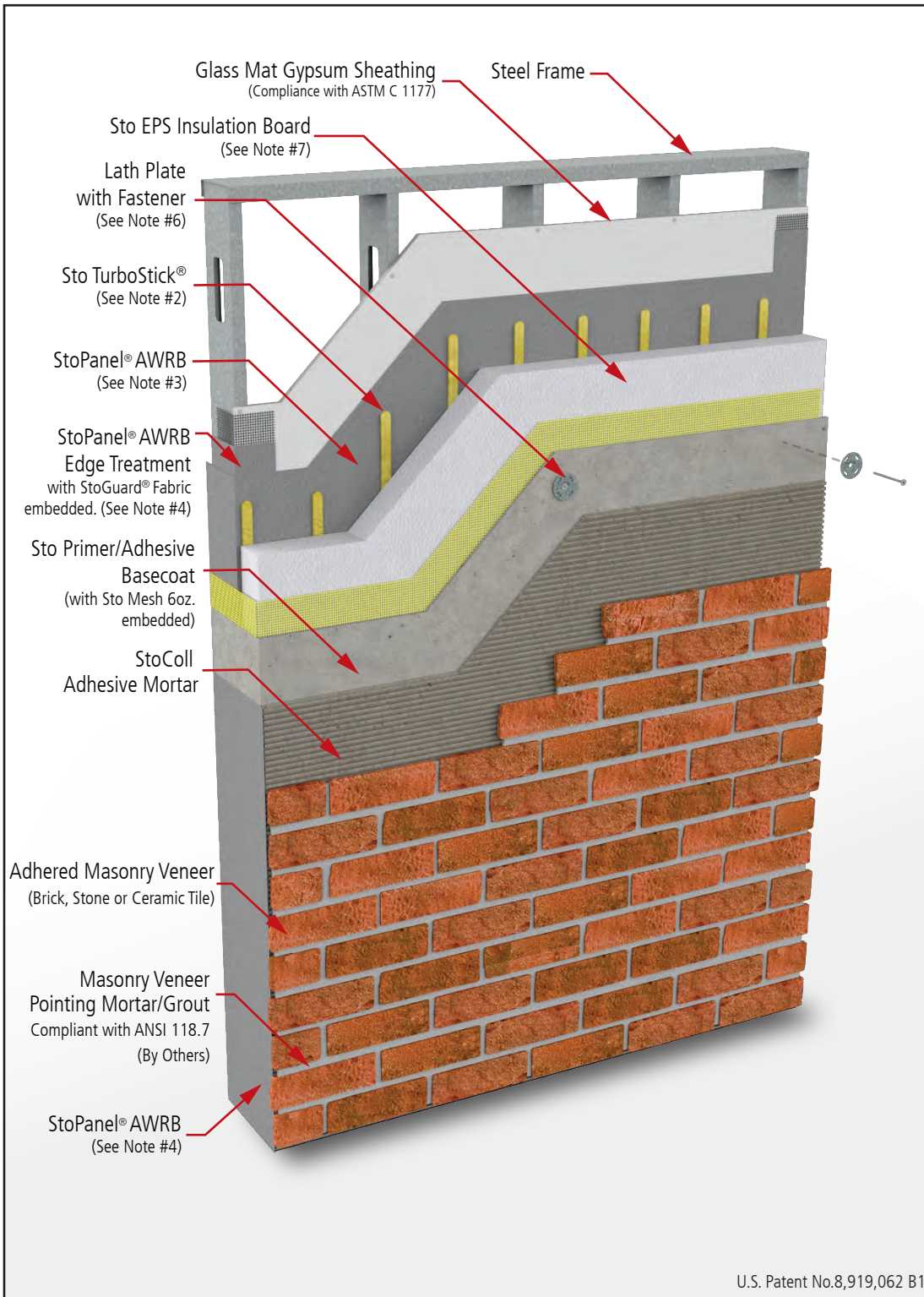

Detail No.: **51.100**  
 Date: **October 2023**  
 Page: **1 of 2**

**Notes:**

1. StoPanel® MVES ci is an engineered insulating wall system with Adhered Masonry Veneer (AMV) – thin brick, natural stone, ceramic tile, or cultured stone. It combines an air and water-resistant barrier (AWRB) with excellent thermal performance and the durability of Sto’s high strength masonry veneer adhesive.
2. Vertical ribbons of adhesive to provide channels for drainage.
3. Alternative air and water resistive barriers (AWRB): Sto Gold Coat®, Sto AirSeal®, and StoGuard® VaporSeal (requires Sto TurboStick™ Adhesive)
4. Alternative Edge and Joint Treatment: Sto RapidGuard®.
5. Install weep tubes nominal 24” apart and align with mortar joints. Extension outboard of veneer is optional.
6. Corrosion resistant fastener installed over reinforced base coat when dry, with 1-1/4 inch (32mm) diameter flat galvanized steel lath-plate (legless) washer. Space fasteners horizontally at no more than 16 inches (406mm) on center, vertically at no more than 36 inches (914mm) on center, and not more than 6” from end or edge terminations.
7. Sto EPS Insulation Board: nominal 1lb/ft<sup>3</sup> expanded polystyrene insulation, minimum 1 inch thick, maximum 4 inches thick, in compliance with ASTM E2430. Alternative: Sto GPS Board
8. Components not identified as Sto are furnished by other manufacturers.

**ATTENTION**

Sto products are intended for use by qualified professional contractors, not consumers, as a component of a larger construction assembly as specified by a qualified design professional, general contractor or builder. They should be installed in accordance with those specifications and Sto’s instructions. Sto Corp. disclaims all, and assumes no, liability for on-site inspections, for its products applied improperly, or by unqualified persons or entities, or as part of an improperly designed or constructed building, for the nonperformance of adjacent building components or assemblies, or for other construction activities beyond Sto’s control. Improper use of Sto products or use as part of an improperly designed or constructed larger assembly or building may result in serious damage to Sto products, and to the structure of the building or its components.

**STO CORP. DISCLAIMS ALL WARRANTIES EXPRESSED OR IMPLIED EXCEPT FOR EXPLICIT LIMITED WRITTEN WARRANTIES ISSUED TO AND ACCEPTED BY BUILDING OWNERS IN ACCORDANCE WITH STO’S WARRANTY PROGRAMS WHICH ARE SUBJECT TO CHANGE FROM TIME TO TIME.** For the fullest, most current information on proper application, clean-up, mixing and other specifications and warranties, cautions and disclaimers, please refer to the Sto Corp. website, [www.stocorp.com](http://www.stocorp.com).

Property of Sto Corp. All Rights Reserved.

[www.stopanel.com](http://www.stopanel.com)



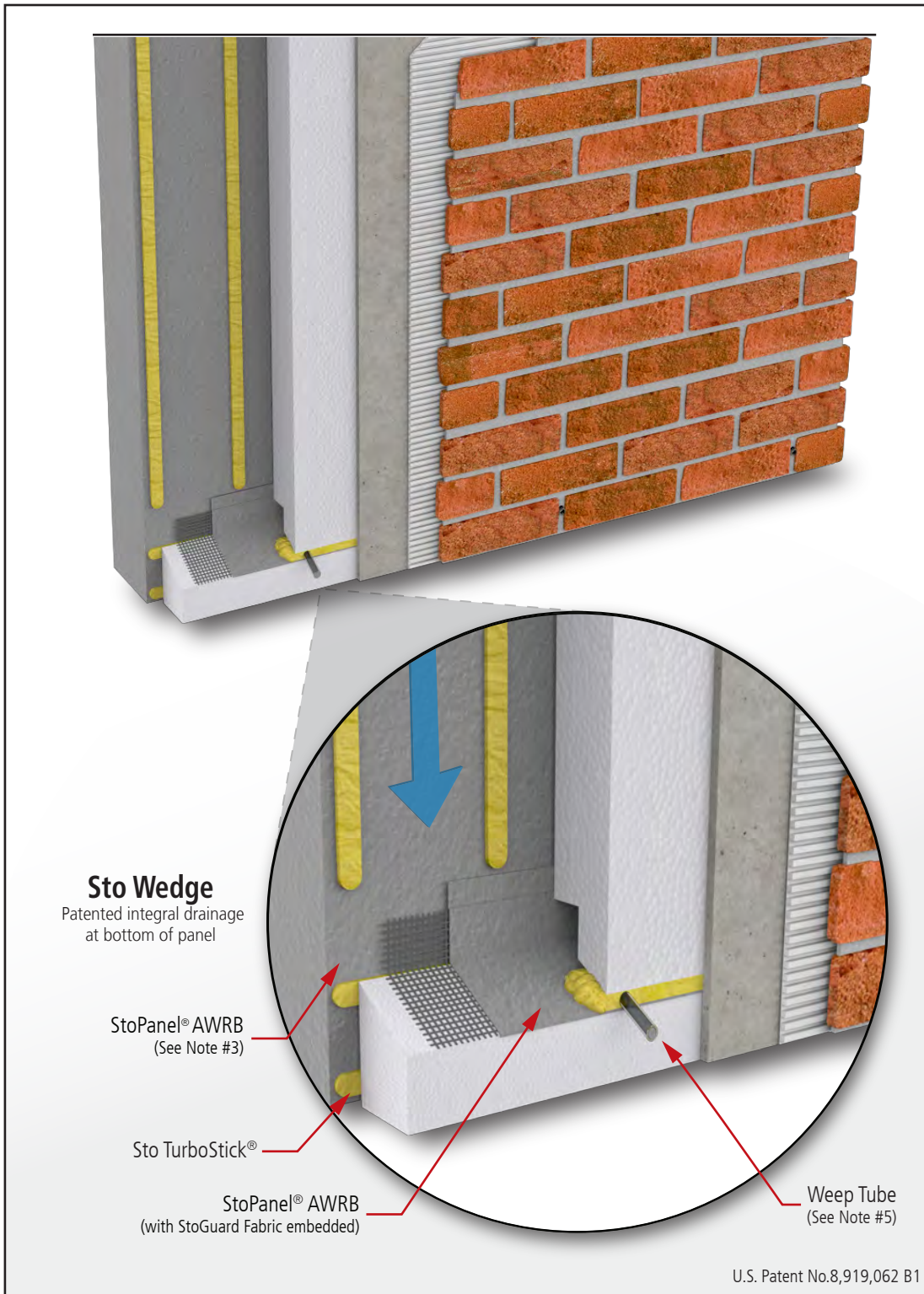

Detail No.: **51.100**  
 Date: **October 2023**  
 Page: **2 of 2**

**Notes:**

1. StoPanel® MVES ci is an engineered insulating wall system with Adhered Masonry Veneer (AMV) – thin brick, natural stone, ceramic tile, or cultured stone. It combines an air and water-resistive barrier (AWRB) with excellent thermal performance and the durability of Sto’s high strength masonry veneer adhesive.
2. Vertical ribbons of adhesive to provide channels for drainage.
3. Alternative air and water resistive barriers (AWRB): Sto Gold Coat®, Sto AirSeal®, and StoGuard® VaporSeal (requires Sto TurboStick™ Adhesive)
4. Alternative Edge and Joint Treatment: Sto RapidGuard®.
5. Install weep tubes nominal 24” apart and align with mortar joints. Extension outbound of veneer is optional.
6. Corrosion resistant fastener installed over reinforced base coat when dry, with 1-1/4 inch (32mm) diameter flat galvanized steel lath-plate (legless) washer. Space fasteners horizontally at no more than 16 inches(406mm) on center, vertically at no more than 36 inches (914mm) on center, and not more than 6” from end or edge terminations.
7. Sto EPS Insulation Board: nominal 1lb/ft<sup>3</sup> expanded polystyrene insulation, minimum 1 inch thick, maximum 4 inches thick, in compliance with ASTM E2430. Alternative: Sto GPS Board
8. Components not identified as Sto are furnished by other manufacturers.

**ATTENTION**

Property of Sto Corp. All Rights Reserved.

Sto products are intended for use by qualified professional contractors, not consumers, as a component of a larger construction assembly as specified by a qualified design professional, general contractor or builder. They should be installed in accordance with those specifications and Sto’s instructions. Sto Corp. disclaims all, and assumes no, liability for on-site inspections, for its products applied improperly, or by unqualified persons or entities, or as part of an improperly designed or constructed building, for the nonperformance of adjacent building components or assemblies, or for other construction activities beyond Sto’s control. Improper use of Sto products or use as part of an improperly designed or constructed larger assembly or building may result in serious damage to Sto products, and to the structure of the building or its components.

STO CORP. DISCLAIMS ALL WARRANTIES EXPRESSED OR IMPLIED EXCEPT FOR EXPLICIT LIMITED WRITTEN WARRANTIES ISSUED TO AND ACCEPTED BY BUILDING OWNERS IN ACCORDANCE WITH STO’S WARRANTY PROGRAMS WHICH ARE SUBJECT TO CHANGE FROM TIME TO TIME. For the fullest, most current information on proper application, clean-up, mixing and other specifications and warranties, cautions and disclaimers, please refer to the Sto Corp. website, [www.stocorp.com](http://www.stocorp.com).

[www.stopanel.com](http://www.stopanel.com)



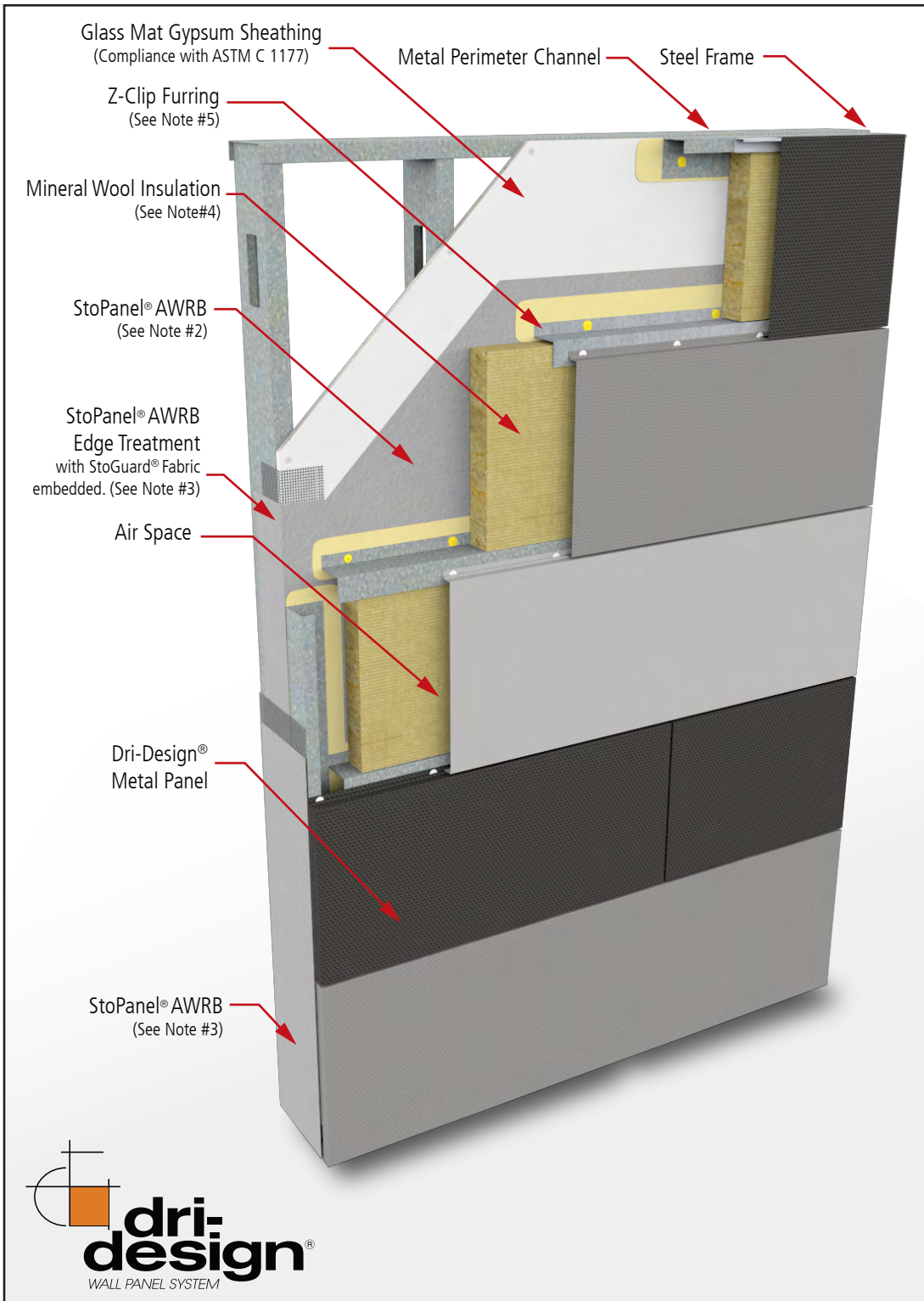

Detail No.: **51.62**

Date: **October 2023**

Page: **1 of 1**

### Notes:

1. StoPanel®Dri-Design® is a lightweight energy efficient pre-fabricated exterior wall panel with continuous air and water-resistive barrier (AWRB), sub-construction, mineral wool insulation and multiple aesthetic options using high quality Dri-Design® metal panels.

2. Alternative air and water resistive barriers (AWRB): Sto Gold Coat®, Sto AirSeal®, and StoGuard® VaporSeal.

3. Alternative Edge and Joint Treatment: Sto RapidGuard®.

4. Mineral Wool Insulation: Minimum 4lb/ft<sup>3</sup> density, Minimum 2" thick.

5. Z-Clip Furring and metal Perimeter Channel set in wet Sto RapidGuard®. Cover fastener heads with dab of Sto RapidGuard®.

6. Components not identified as Sto are furnished by other manufacturers.

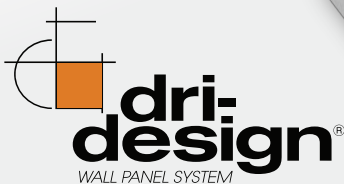

### ATTENTION

Property of Sto Corp. All Rights Reserved.

Sto products are intended for use by qualified professional contractors, not consumers, as a component of a larger construction assembly as specified by a qualified design professional, general contractor or builder. They should be installed in accordance with those specifications and Sto's instructions. Sto Corp. disclaims all, and assumes no, liability for on-site inspections, for its products applied improperly, or by unqualified persons or entities, or as part of an improperly designed or constructed building, for the nonperformance of adjacent building components or assemblies, or for other construction activities beyond Sto's control. Improper use of Sto products or use as part of an improperly designed or constructed larger assembly or building may result in serious damage to Sto products, and to the structure of the building or its components.

**STO CORP. DISCLAIMS ALL WARRANTIES EXPRESSED OR IMPLIED EXCEPT FOR EXPLICIT LIMITED WRITTEN WARRANTIES ISSUED TO AND ACCEPTED BY BUILDING OWNERS IN ACCORDANCE WITH STO'S WARRANTY PROGRAMS WHICH ARE SUBJECT TO CHANGE FROM TIME TO TIME.** For the fullest, most current information on proper application, clean-up, mixing and other specifications and warranties, cautions and disclaimers, please refer to the Sto Corp. website, [www.stocorp.com](http://www.stocorp.com).

[www.stopanel.com](http://www.stopanel.com)



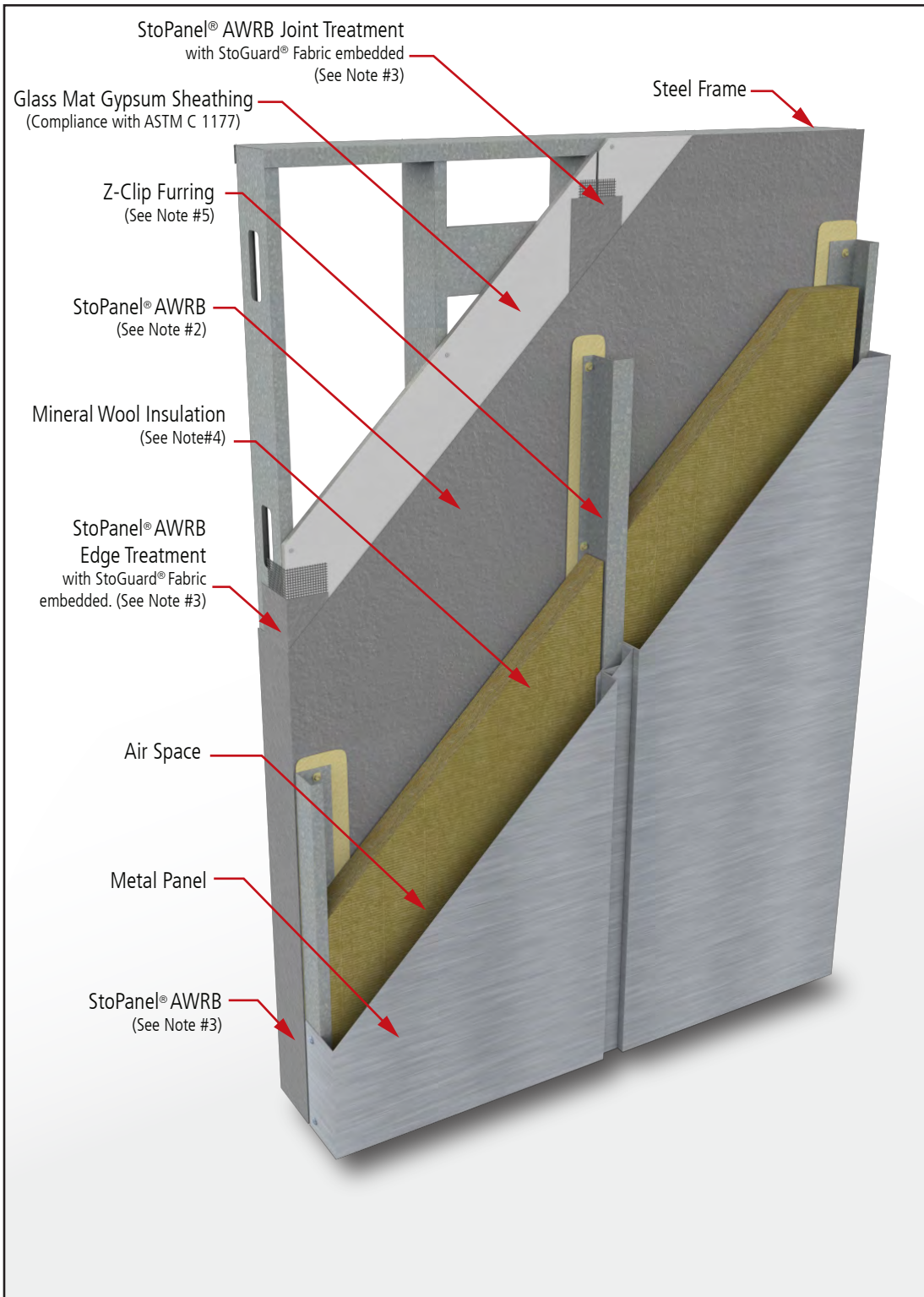

Detail No.: **51.60**  
 Date: **October 2023**  
 Page: **1 of 1**

**Notes:**

1. StoPanel®Metal ci is a lightweight energy efficient pre-fabricated exterior wall panel with continuous air and water-resistive barrier (AWRB), sub-construction, mineral wool insulation and multiple aesthetic options using high quality metal panels.
2. Alternative air and water resistive barriers (AWRB): Sto Gold Coat®, Sto AirSeal®, and StoGuard® VaporSeal.
3. Alternative Edge and Joint Treatment: Sto RapidGuard®.
4. Mineral Wool Insulation: Minimum 4lb/ft<sup>3</sup> density, Minimum 2" thick.
5. Z-Clip Furring and metal Perimeter Channel set in wet Sto RapidGuard®. Cover fastener heads with dab of Sto RapidGuard®.
6. Components not identified as Sto are furnished by other manufacturers.

**ATTENTION**

Property of Sto Corp. All Rights Reserved.

Sto products are intended for use by qualified professional contractors, not consumers, as a component of a larger construction assembly as specified by a qualified design professional, general contractor or builder. They should be installed in accordance with those specifications and Sto's instructions. Sto Corp. disclaims all, and assumes no, liability for on-site inspections, for its products applied improperly, or by unqualified persons or entities, or as part of an improperly designed or constructed building, for the nonperformance of adjacent building components or assemblies, or for other construction activities beyond Sto's control. Improper use of Sto products or use as part of an improperly designed or constructed larger assembly or building may result in serious damage to Sto products, and to the structure of the building or its components.

STO CORP. DISCLAIMS ALL WARRANTIES EXPRESSED OR IMPLIED EXCEPT FOR EXPLICIT LIMITED WRITTEN WARRANTIES ISSUED TO AND ACCEPTED BY BUILDING OWNERS IN ACCORDANCE WITH STO'S WARRANTY PROGRAMS WHICH ARE SUBJECT TO CHANGE FROM TIME TO TIME.  
 For the fullest, most current information on proper application, clean-up, mixing and other specifications and warranties, cautions and disclaimers, please refer to the Sto Corp. website, [www.stocorp.com](http://www.stocorp.com).

[www.stopanel.com](http://www.stopanel.com)



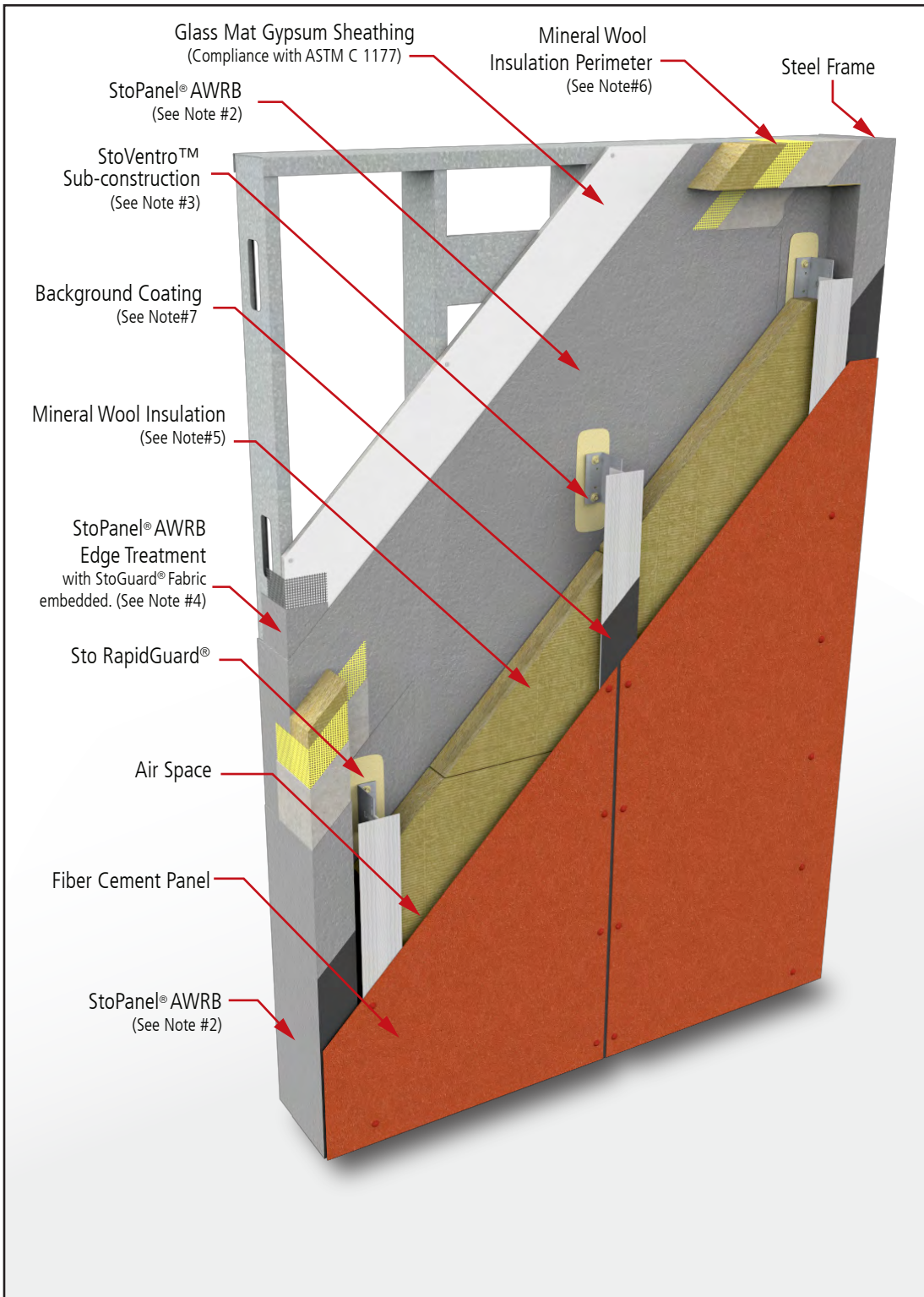

Detail No.: **51.61.02**  
 Date: **October 2023**  
 Page: **1 of 1**

- Notes:**
1. StoPanel® Fiber Cement ci is a lightweight energy efficient pre-fabricated exterior wall panel with continuous air and water-resistive barrier (AWRB), sub-construction, mineral wool insulation and multiple aesthetic options using fiber cement panels.
  2. Alternative air and water resistive barriers (AWRB): Sto Gold Coat®, Sto AirSeal®, and StoGuard® VaporSeal.
  3. Sub-construction: StoVentro™ Brackets set in wet Sto RapidGuard®. StoVentro™ T-Profiles are attached to the StoVentro™ brackets using StoVentro™ sub-construction screws. Add dab of Sto RapidGuard® over bracket fastener screw heads.
  4. Alternative Edge and Joint Treatment: Sto RapidGuard®.
  5. Mineral Wool Insulation: Minimum 4lb/ft3 density, Minimum 2" thick.
  6. Owens Corning® Thermafiber® CI-C SC18 Mineral Wool Insulation Perimeter (sloped at bottom of panel), wrapped in Sto BTS Plus, Sto Mesh and StoPanel® AWRB coating.
  7. StoVentro™ Sub-construction, at panel joints, can be darkened with compatible aerosolized paint.
  8. Sto Thermal Blocking Element used under StoVentro™ Sub-construction brackets if defined by thermal requirements.
  9. Components not identified as Sto are furnished by other manufacturers.

**ATTENTION**

Property of Sto Corp. All Rights Reserved.

Sto products are intended for use by qualified professional contractors, not consumers, as a component of a larger construction assembly as specified by a qualified design professional, general contractor or builder. They should be installed in accordance with those specifications and Sto's instructions. Sto Corp. disclaims all, and assumes no, liability for on-site inspections, for its products applied improperly, or by unqualified persons or entities, or as part of an improperly designed or constructed building, for the nonperformance of adjacent building components or assemblies, of for other construction activities beyond Sto's control. Improper use of Sto products or use as part of an improperly designed or constructed larger assembly or building may result in serious damage to Sto products, and to the structure of the building or its components.

STO CORP. DISCLAIMS ALL WARRANTIES EXPRESSED OR IMPLIED EXCEPT FOR EXPLICIT LIMITED WRITTEN WARRANTIES ISSUED TO AND ACCEPTED BY BUILDING OWNERS IN ACCORDANCE WITH STO'S WARRANTY PROGRAMS WHICH ARE SUBJECT TO CHANGE FROM TIME TO TIME. For the fullest, most current information on proper application, clean-up, mixing and other specifications and warranties, cautions and disclaimers, please refer to the Sto Corp. website, [www.stocorp.com](http://www.stocorp.com).

[www.stopanel.com](http://www.stopanel.com)



# StoPanel® LM Impact ci

## Large Missile

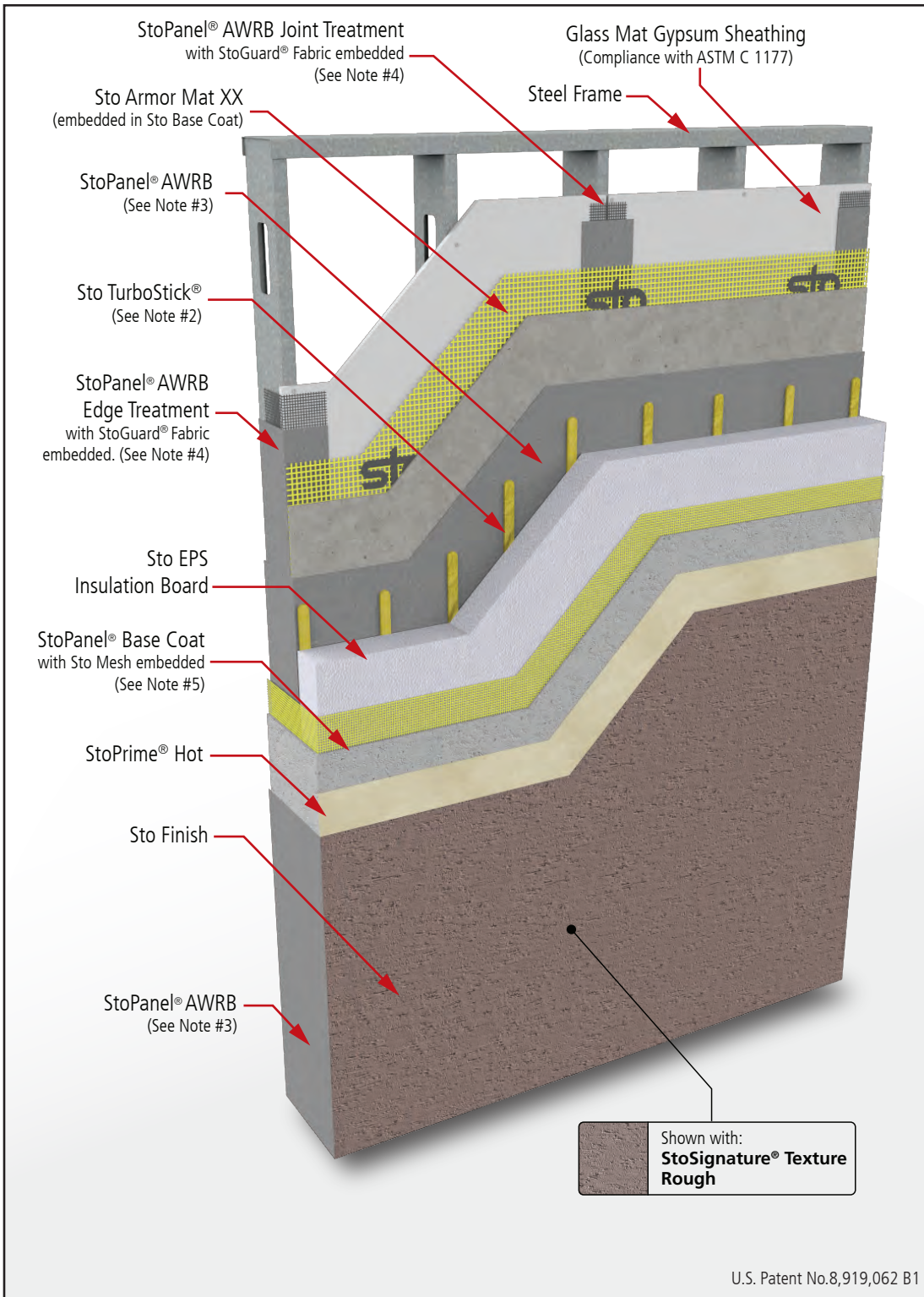

Detail No.: **51.10**  
 Date: **October 2023**  
 Page: **1 of 2**

### Notes:

1. StoPanel® LM Impact ci is a lightweight, hurricane impact resistant, energy efficient pre-fabricated exterior wall panel with continuous air and water-resistant barrier (AWRB). The panel can be finished with a wide variety of Sto textured finishes, Sto specialty finishes, and StoCast finishes.
2. Vertical ribbons of adhesive to provide channels for drainage. Alternative adhesives: Sto BTS® Plus, Sto Primer/Adhesive-B, Sto Primer/Adhesive (with their prescribed adhesive ribbon spacing).
3. Alternative air and water resistant barriers (AWRB): Sto Gold Coat®, Sto AirSeal®, and StoGuard® VaporSeal (requires Sto TurboStick™ Adhesive)
4. Alternative Edge and Joint Treatment: Sto RapidGuard®.
5. Alternative base coats: Sto BTS® Plus, Sto Primer/Adhesive-B, and Sto Primer/Adhesive (requires Sto textured finish).
6. Components not identified as Sto are furnished by other manufacturers.

**IMPORTANT:** Refer to Sto Corp. Miami-Dade NOAs and Florida Building Code listings for specific panel components where these codes are in effect.

### ATTENTION

Sto products are intended for use by qualified professional contractors, not consumers, as a component of a larger construction assembly as specified by a qualified design professional, general contractor or builder. They should be installed in accordance with those specifications and Sto's instructions. Sto Corp. disclaims all, and assumes no, liability for on-site inspections, for its products applied improperly, or by unqualified persons or entities, or as part of an improperly designed or constructed building, for the nonperformance of adjacent building components or assemblies, or for other construction activities beyond Sto's control. Improper use of Sto products or use as part of an improperly designed or constructed larger assembly or building may result in serious damage to Sto products, and to the structure of the building or its components.

**STO CORP. DISCLAIMS ALL WARRANTIES EXPRESSED OR IMPLIED EXCEPT FOR EXPLICIT LIMITED WRITTEN WARRANTIES ISSUED TO AND ACCEPTED BY BUILDING OWNERS IN ACCORDANCE WITH STO'S WARRANTY PROGRAMS WHICH ARE SUBJECT TO CHANGE FROM TIME TO TIME.** For the fullest, most current information on proper application, clean-up, mixing and other specifications and warranties, cautions and disclaimers, please refer to the Sto Corp. website, [www.stocorp.com](http://www.stocorp.com).

Property of Sto Corp. All Rights Reserved.

[www.stopanel.com](http://www.stopanel.com)



# StoPanel® LM Impact ci

## Large Missile

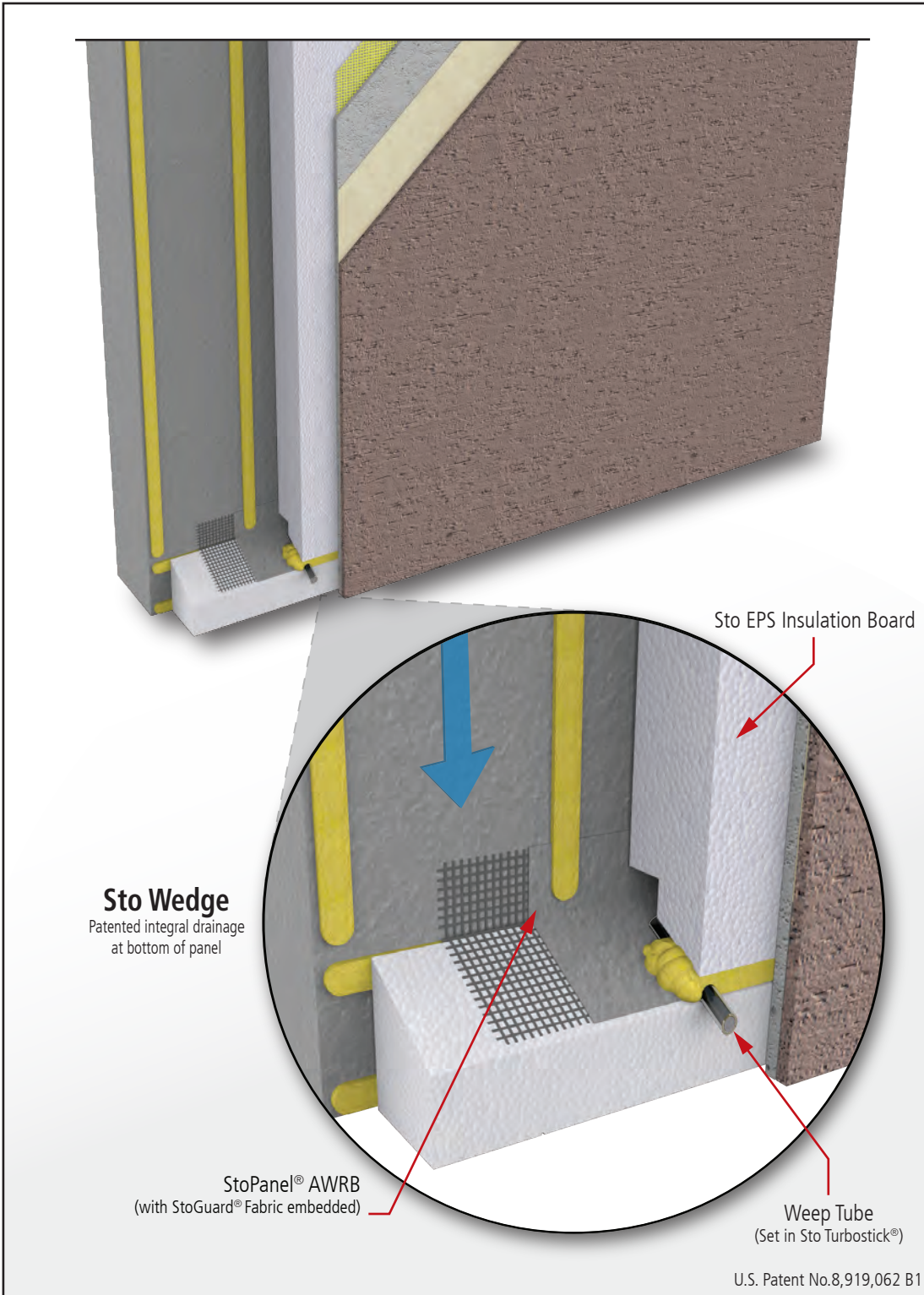

Detail No.: **51.10**  
 Date: **October 2023**  
 Page: **2 of 2**

### Notes:

1. StoPanel® LM Impact ci is a lightweight, hurricane impact resistant, energy efficient pre-fabricated exterior wall panel with continuous air and water-resistive barrier (AWRB). The panel can be finished with a wide variety of Sto textured finishes, Sto specialty finishes, and StoCast finishes.
2. Vertical ribbons of adhesive to provide channels for drainage. Alternative adhesives: Sto BTS® Plus, Sto Primer/Adhesive-B, Sto Primer/Adhesive (with their prescribed adhesive ribbon spacing).
3. Alternative air and water resistive barriers (AWRB): Sto Gold Coat®, Sto AirSeal®, and StoGuard® VaporSeal (requires Sto TurboStick™ Adhesive)
4. Alternative Edge and Joint Treatment: Sto RapidGuard®.
5. Alternative base coats: Sto BTS® Plus, Sto Primer/Adhesive-B, and Sto Primer/Adhesive (requires Sto textured finish).
6. Components not identified as Sto are furnished by other manufacturers.

**IMPORTANT:** Refer to Sto Corp. Miami-Dade NOAs and Florida Building Code listings for specific panel components where these codes are in effect.

**Sto Wedge**  
 Patented integral drainage at bottom of panel

StoPanel® AWRB  
 (with StoGuard® Fabric embedded)

Sto EPS Insulation Board

Weep Tube  
 (Set in Sto Turbostick®)

U.S. Patent No.8,919,062 B1

### ATTENTION

Property of Sto Corp. All Rights Reserved.

Sto products are intended for use by qualified professional contractors, not consumers, as a component of a larger construction assembly as specified by a qualified design professional, general contractor or builder. They should be installed in accordance with those specifications and Sto's instructions. Sto Corp. disclaims all, and assumes no, liability for on-site inspections, for its products applied improperly, or by unqualified persons or entities, or as part of an improperly designed or constructed building, for the nonperformance of adjacent building components or assemblies, of for other construction activities beyond Sto's control. Improper use of Sto products or use as part of an improperly designed or constructed larger assembly or building may result in serious damage to Sto products, and to the structure of the building or its components.

STO CORP. DISCLAIMS ALL WARRANTIES EXPRESSED OR IMPLIED EXCEPT FOR EXPLICIT LIMITED WRITTEN WARRANTIES ISSUED TO AND ACCEPTED BY BUILDING OWNERS IN ACCORDANCE WITH STO'S WARRANTY PROGRAMS WHICH ARE SUBJECT TO CHANGE FROM TIME TO TIME. For the fullest, most current information on proper application, clean-up, mixing and other specifications and warranties, cautions and disclaimers, please refer to the Sto Corp. website, [www.stocorp.com](http://www.stocorp.com).

[www.stopanel.com](http://www.stopanel.com)



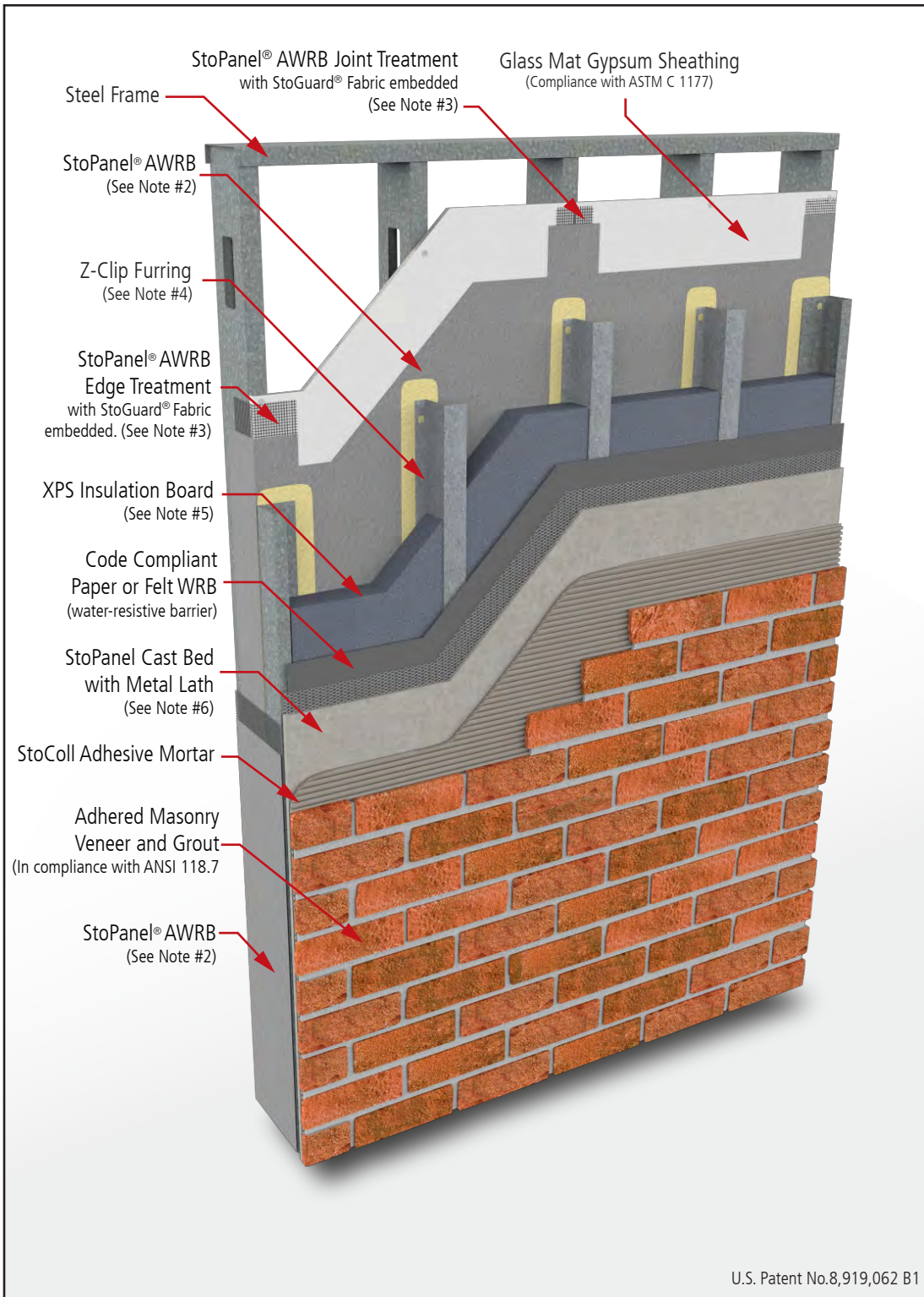

Detail No.: **51.40**  
 Date: **October 2023**  
 Page: **1 of 2**

**Notes:**

1. StoPanel® Brick ci is a lightweight energy efficient pre-fabricated exterior wall panel with extruded polystyrene (XPS) insulation, continuous air and water-resistive barrier (AWRB), and can be finished with a wide variety of masonry veneer options.
2. Alternative air and water resistive barriers (AWRB): Sto Gold Coat®, Sto AirSeal®, and StoGuard® VaporSeal.
3. Alternative Edge and Joint Treatment: Sto RapidGuard®
4. Z-Clip Furring and metal Perimeter Channel set in wet Sto RapidGuard®. Cover fastener heads with dab of Sto RapidGuard®.
5. XPS Insulation: ASTM C 578, Type IV compliant.
6. Minimum 3.4 lb./yd<sup>2</sup> self-furred galvanized steel diamond mesh metal lath in compliance with ASTM C 847.
7. Components not identified as Sto are furnished by other manufacturers.

**ATTENTION**

Property of Sto Corp. All Rights Reserved.

Sto products are intended for use by qualified professional contractors, not consumers, as a component of a larger construction assembly as specified by a qualified design professional, general contractor or builder. They should be installed in accordance with those specifications and Sto's instructions. Sto Corp. disclaims all, and assumes no, liability for on-site inspections, for its products applied improperly, or by unqualified persons or entities, or as part of an improperly designed or constructed building, for the nonperformance of adjacent building components or assemblies, or for other construction activities beyond Sto's control. Improper use of Sto products or use as part of an improperly designed or constructed larger assembly or building may result in serious damage to Sto products, and to the structure of the building or its components.

STO CORP. DISCLAIMS ALL WARRANTIES EXPRESSED OR IMPLIED EXCEPT FOR EXPLICIT LIMITED WRITTEN WARRANTIES ISSUED TO AND ACCEPTED BY BUILDING OWNERS IN ACCORDANCE WITH STO'S WARRANTY PROGRAMS WHICH ARE SUBJECT TO CHANGE FROM TIME TO TIME. For the fullest, most current information on proper application, clean-up, mixing and other specifications and warranties, cautions and disclaimers, please refer to the Sto Corp. website, [www.stocorp.com](http://www.stocorp.com).

[www.stopanel.com](http://www.stopanel.com)





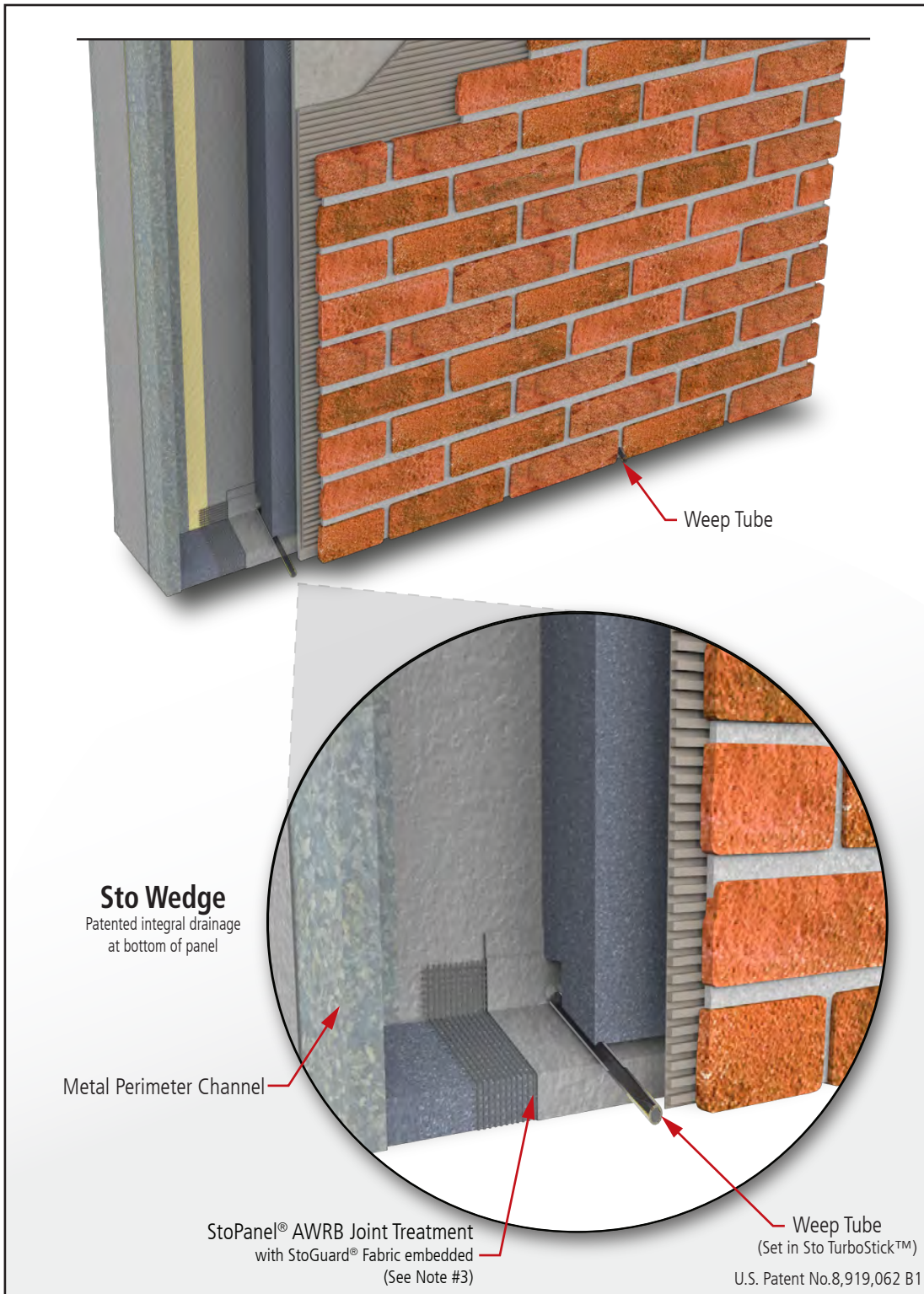

Detail No.: **51.40**  
Date: **October 2023**  
Page: **2 of 2**

**Notes:**

1. StoPanel® Brick ci is a lightweight energy efficient pre-fabricated exterior wall panel with extruded polystyrene (XPS), continuous air and water-resistant barrier (AWRB), and can be finished with a wide variety of masonry veneer options.
2. Alternative air and water resistive barriers (AWRB): Sto Gold Coat®, Sto AirSeal®, and StoGuard® VaporSeal.
3. Alternative Edge and Joint Treatment: Sto RapidGuard®
4. Z-Clip Furring and metal Perimeter Channel set in wet Sto RapidGuard®. Cover fastener heads with dab of Sto RapidGuard®.
5. XPS Insulation: ASTM C 578, Type IV compliant.
6. Minimum 3.4 lb./yd<sup>2</sup> self-furred galvanized steel diamond mesh metal lath in compliance with ASTM C 847.
7. Components not identified as Sto are furnished by other manufacturers.

**ATTENTION**

Property of Sto Corp. All Rights Reserved.

Sto products are intended for use by qualified professional contractors, not consumers, as a component of a larger construction assembly as specified by a qualified design professional, general contractor or builder. They should be installed in accordance with those specifications and Sto's instructions. Sto Corp. disclaims all, and assumes no, liability for on-site inspections, for its products applied improperly, or by unqualified persons or entities, or as part of an improperly designed or constructed building, for the nonperformance of adjacent building components or assemblies, or for other construction activities beyond Sto's control. Improper use of Sto products or use as part of an improperly designed or constructed larger assembly or building may result in serious damage to Sto products, and to the structure of the building or its components.

STO CORP. DISCLAIMS ALL WARRANTIES EXPRESSED OR IMPLIED EXCEPT FOR EXPLICIT LIMITED WRITTEN WARRANTIES ISSUED TO AND ACCEPTED BY BUILDING OWNERS IN ACCORDANCE WITH STO'S WARRANTY PROGRAMS WHICH ARE SUBJECT TO CHANGE FROM TIME TO TIME. For the fullest, most current information on proper application, clean-up, mixing and other specifications and warranties, cautions and disclaimers, please refer to the Sto Corp. website, [www.stocorp.com](http://www.stocorp.com).

[www.stopanel.com](http://www.stopanel.com)



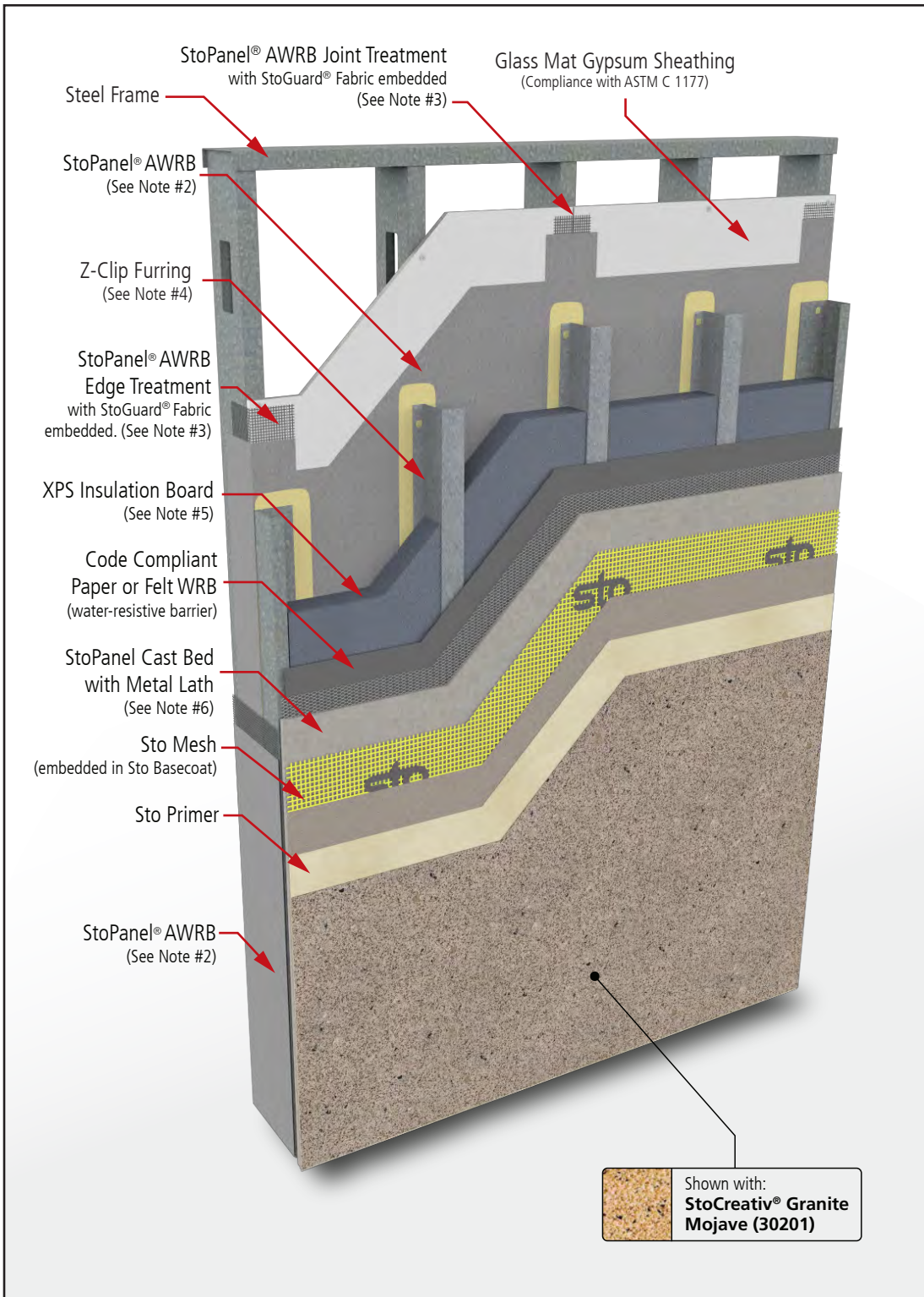

Detail No.: **51.55**  
 Date: **October 2023**  
 Page: **1 of 2**

**Notes:**

1. StoPanel® Precast ci is a lightweight, energy efficient pre-fabricated exterior wall panel with a continuous air & moisture barrier, XPS exterior insulation and a variety of integral decorative & protective finish options to replicate precast concrete; all at a fraction of the weight of precast concrete.
2. Alternative air and water resistive barriers (AWRB): Sto Gold Coat®, Sto AirSeal®, and StoGuard® VaporSeal.
3. Alternative Edge and Joint Treatment: Sto RapidGuard®
4. Z-Clip Furring and metal Perimeter Channel set in wet Sto RapidGuard®. Cover fastener heads with dab of Sto RapidGuard®.
5. XPS Insulation: ASTM C 578, Type IV compliant.
6. Minimum 3.4 lb./yd<sup>2</sup> self-furred galvanized steel diamond mesh metal lath in compliance with ASTM C 847.
7. Components not identified as Sto are furnished by other manufacturers.

**ATTENTION**

Property of Sto Corp. All Rights Reserved.

Sto products are intended for use by qualified professional contractors, not consumers, as a component of a larger construction assembly as specified by a qualified design professional, general contractor or builder. They should be installed in accordance with those specifications and Sto's instructions. Sto Corp. disclaims all, and assumes no, liability for on-site inspections, for its products applied improperly, or by unqualified persons or entities, or as part of an improperly designed or constructed building, for the nonperformance of adjacent building components or assemblies, or for other construction activities beyond Sto's control. Improper use of Sto products or use as part of an improperly designed or constructed larger assembly or building may result in serious damage to Sto products, and to the structure of the building or its components.

**STO CORP. DISCLAIMS ALL WARRANTIES EXPRESSED OR IMPLIED EXCEPT FOR EXPLICIT LIMITED WRITTEN WARRANTIES ISSUED TO AND ACCEPTED BY BUILDING OWNERS IN ACCORDANCE WITH STO'S WARRANTY PROGRAMS WHICH ARE SUBJECT TO CHANGE FROM TIME TO TIME.** For the fullest, most current information on proper application, clean-up, mixing and other specifications and warranties, cautions and disclaimers, please refer to the Sto Corp. website, [www.stocorp.com](http://www.stocorp.com).

[www.stopanel.com](http://www.stopanel.com)



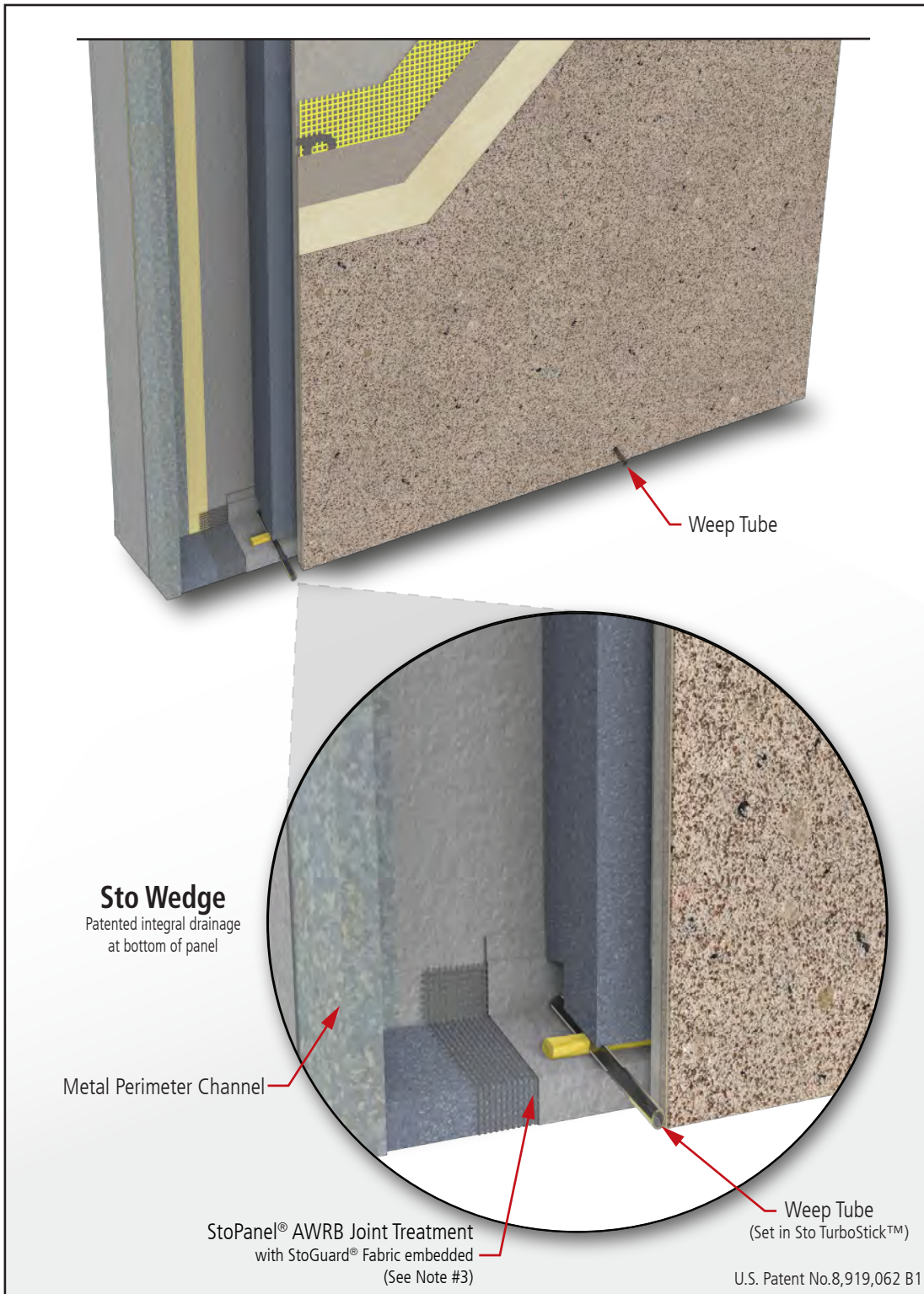

Detail No.: **51.55**  
 Date: **October 2023**  
 Page: **2 of 2**

**Notes:**

1. StoPanel® Precast ci is a lightweight, energy efficient pre-fabricated exterior wall panel with a continuous air & moisture barrier, XPS exterior insulation and a variety of integral decorative & protective finish options to replicate precast concrete; all at a fraction of the weight of precast concrete.
2. Alternative air and water resistive barriers (AWRB): Sto Gold Coat®, Sto AirSeal®, and StoGuard® VaporSeal.
3. Alternative Edge and Joint Treatment: Sto RapidGuard®
4. Z-Clip Furring and metal Perimeter Channel set in wet Sto RapidGuard®. Cover fastener heads with dab of Sto RapidGuard®.
5. XPS Insulation: ASTM C 578, Type IV compliant.
6. Minimum 3.4 lb./yd<sup>2</sup> self-furred galvanized steel diamond mesh metal lath in compliance with ASTM C 847.
7. Components not identified as Sto are furnished by other manufacturers.

**ATTENTION**

Property of Sto Corp. All Rights Reserved.

Sto products are intended for use by qualified professional contractors, not consumers, as a component of a larger construction assembly as specified by a qualified design professional, general contractor or builder. They should be installed in accordance with those specifications and Sto's instructions. Sto Corp. disclaims all, and assumes no, liability for on-site inspections, for its products applied improperly, or by unqualified persons or entities, or as part of an improperly designed or constructed building, for the nonperformance of adjacent building components or assemblies, of for other construction activities beyond Sto's control. Improper use of Sto products or use as part of an improperly designed or constructed larger assembly or building may result in serious damage to Sto products, and to the structure of the building or its components.

STO CORP. DISCLAIMS ALL WARRANTIES EXPRESSED OR IMPLIED EXCEPT FOR EXPLICIT LIMITED WRITTEN WARRANTIES ISSUED TO AND ACCEPTED BY BUILDING OWNERS IN ACCORDANCE WITH STO'S WARRANTY PROGRAMS WHICH ARE SUBJECT TO CHANGE FROM TIME TO TIME. For the fullest, most current information on proper application, clean-up, mixing and other specifications and warranties, cautions and disclaimers, please refer to the Sto Corp. website, [www.stocorp.com](http://www.stocorp.com).

[www.stopanel.com](http://www.stopanel.com)



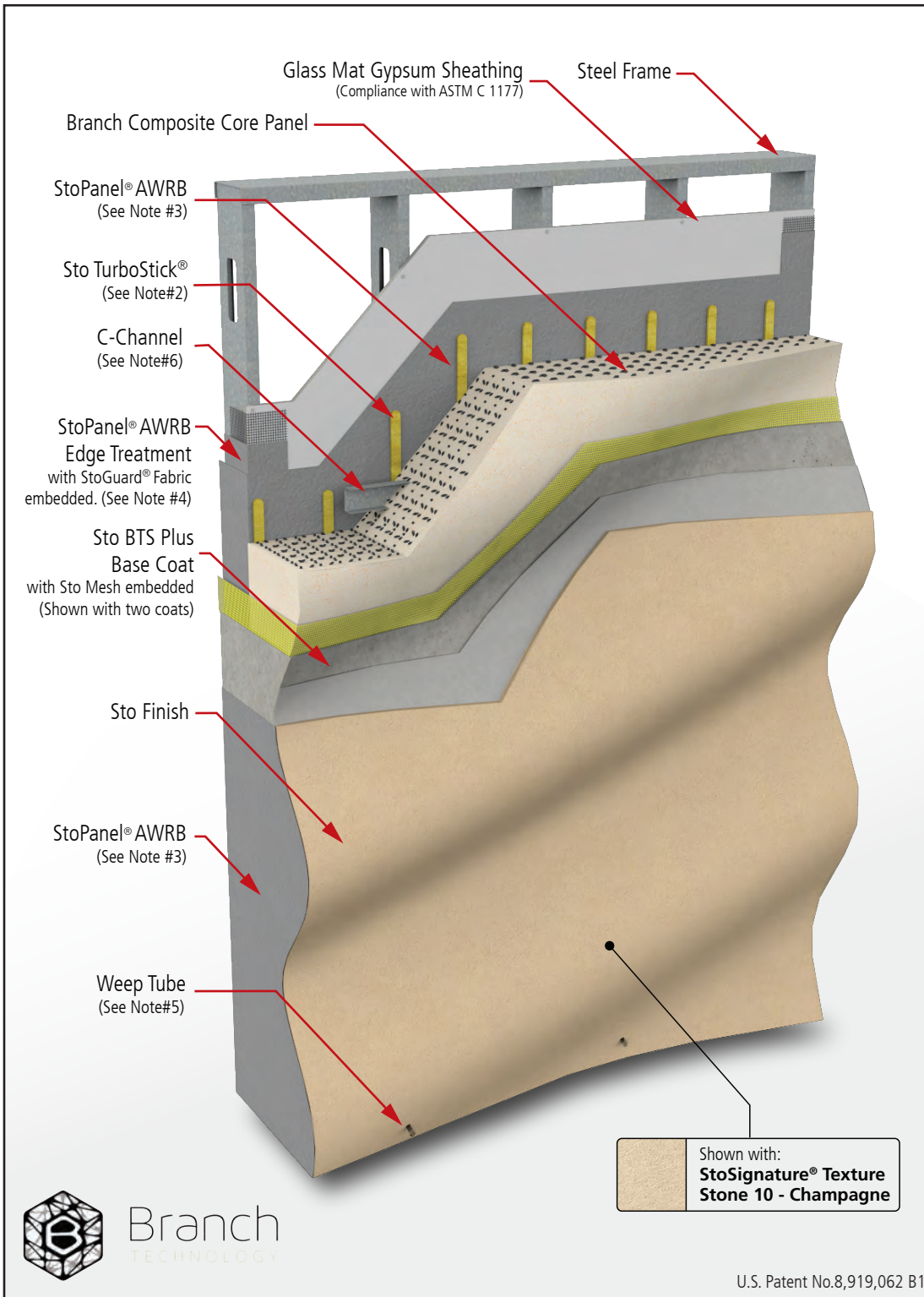

Detail No.: **51.200**  
 Date: **October 2023**  
 Page: **1 of 2**

**Notes:**

1. StoPanel® 3DP is a pre-fabricated drainable exterior wall panel with integral StoGuard® air and water-resistive barrier (AWRB) and a digitally 3D printed R-7/in continuous insulation (ci). The ci component is robotically milled to the architecturally specified contour and factory finished by hand to achieve a highly functional and unique architectural façade panel.
2. Vertical ribbons of adhesive to provide channels for drainage.
3. Alternative air and water resistive barriers (AWRB): Sto Gold Coat®, Sto AirSeal®, and StoGuard® VaporSeal (requires Sto TurboStick™ Adhesive)
4. Alternative Edge and Joint Treatment: Sto RapidGuard®.
5. Install weep tubes nominal 24" on center. Extension outbound of veneer is optional.
6. Fasten into C-Channel with corrosion resistant self-tapping fastener of sufficient length to obtain minimum three-thread penetration into steel.
7. Components not identified as Sto are furnished by other manufacturers.

U.S. Patent No.8,919,062 B1

**ATTENTION**

Property of Sto Corp. All Rights Reserved.

Sto products are intended for use by qualified professional contractors, not consumers, as a component of a larger construction assembly as specified by a qualified design professional, general contractor or builder. They should be installed in accordance with those specifications and Sto's instructions. Sto Corp. disclaims all, and assumes no, liability for on-site inspections, for its products applied improperly, or by unqualified persons or entities, or as part of an improperly designed or constructed building, for the nonperformance of adjacent building components or assemblies, or for other construction activities beyond Sto's control. Improper use of Sto products or use as part of an improperly designed or constructed larger assembly or building may result in serious damage to Sto products, and to the structure of the building or its components.

STO CORP. DISCLAIMS ALL WARRANTIES EXPRESSED OR IMPLIED EXCEPT FOR EXPLICIT LIMITED WRITTEN WARRANTIES ISSUED TO AND ACCEPTED BY BUILDING OWNERS IN ACCORDANCE WITH STO'S WARRANTY PROGRAMS WHICH ARE SUBJECT TO CHANGE FROM TIME TO TIME. For the fullest, most current information on proper application, clean-up, mixing and other specifications and warranties, cautions and disclaimers, please refer to the Sto Corp. website, [www.stocorp.com](http://www.stocorp.com).

[www.stopanel.com](http://www.stopanel.com)



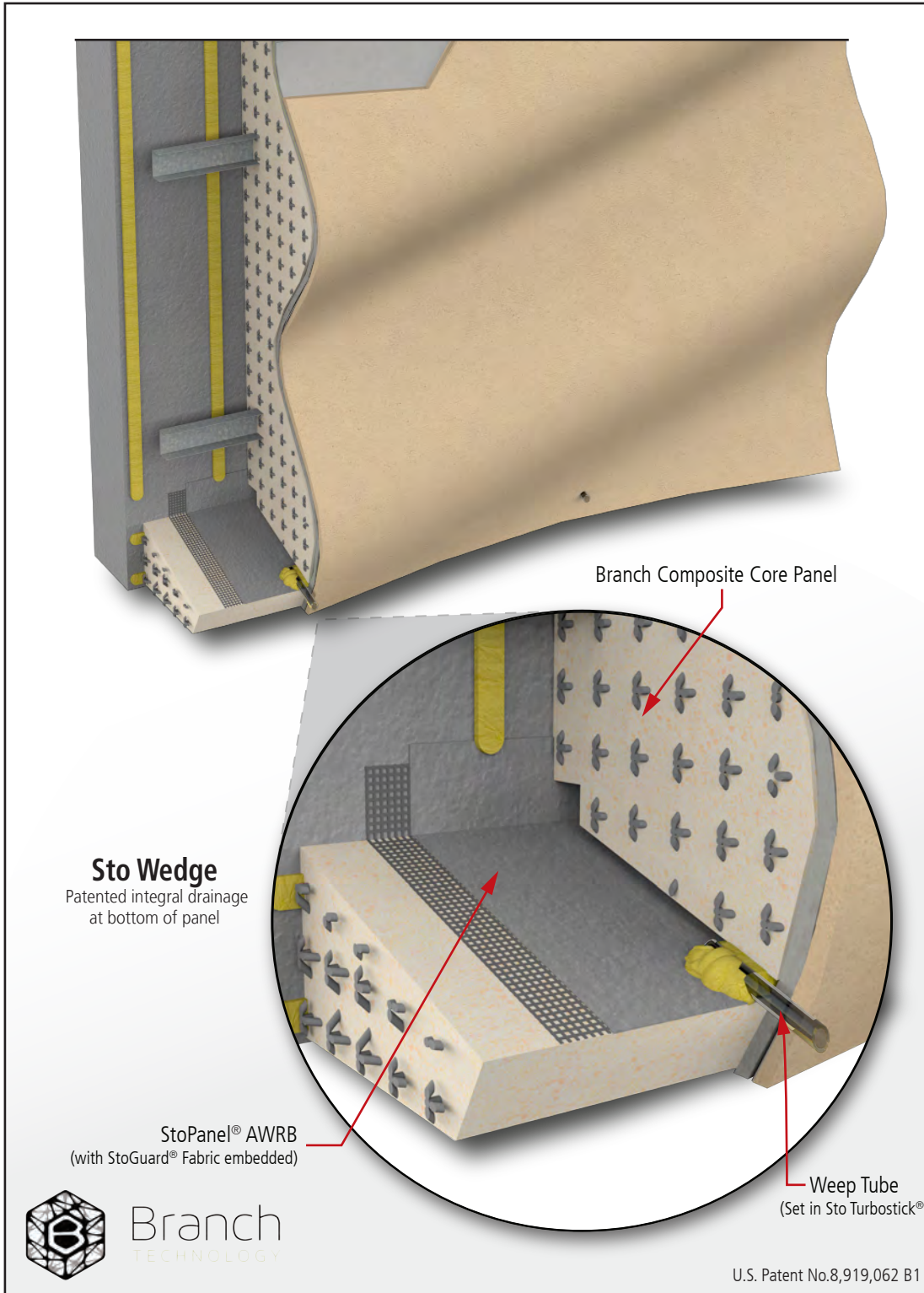

Detail No.: **51.200**  
Date: **October 2023**  
Page: **2 of 2**

**Notes:**

1. StoPanel® 3DP is a pre-fabricated drainable exterior wall panel with integral StoGuard® air and water-resistive barrier (AWRB) and a digitally 3D printed R-7/in continuous insulation (ci). The ci component is robotically milled to the architecturally specified contour and factory finished by hand to achieve a highly functional and unique architectural façade panel.
2. Vertical ribbons of adhesive to provide channels for drainage.
3. Alternative air and water resistive barriers (AWRB): Sto Gold Coat®, Sto AirSeal®, and StoGuard® VaporSeal (requires Sto TurboStick™ Adhesive)
4. Alternative Edge and Joint Treatment: Sto RapidGuard®.
5. Install weep tubes nominal 24" on center. Extension outbound of veneer is optional.
6. Fasten into C-Channel with corrosion resistant self-tapping fastener of sufficient length to obtain minimum three-thread penetration into steel.
7. Components not identified as Sto are furnished by other manufacturers.

U.S. Patent No.8,919,062 B1

**ATTENTION**

Property of Sto Corp. All Rights Reserved.

Sto products are intended for use by qualified professional contractors, not consumers, as a component of a larger construction assembly as specified by a qualified design professional, general contractor or builder. They should be installed in accordance with those specifications and Sto's instructions. Sto Corp. disclaims all, and assumes no, liability for on-site inspections, for its products applied improperly, or by unqualified persons or entities, or as part of an improperly designed or constructed building, for the nonperformance of adjacent building components or assemblies, or for other construction activities beyond Sto's control. Improper use of Sto products or use as part of an improperly designed or constructed larger assembly or building may result in serious damage to Sto products, and to the structure of the building or its components.

STO CORP. DISCLAIMS ALL WARRANTIES EXPRESSED OR IMPLIED EXCEPT FOR EXPLICIT LIMITED WRITTEN WARRANTIES ISSUED TO AND ACCEPTED BY BUILDING OWNERS IN ACCORDANCE WITH STO'S WARRANTY PROGRAMS WHICH ARE SUBJECT TO CHANGE FROM TIME TO TIME. For the fullest, most current information on proper application, clean-up, mixing and other specifications and warranties, cautions and disclaimers, please refer to the Sto Corp. website, [www.stocorp.com](http://www.stocorp.com).

[www.stopanel.com](http://www.stopanel.com)



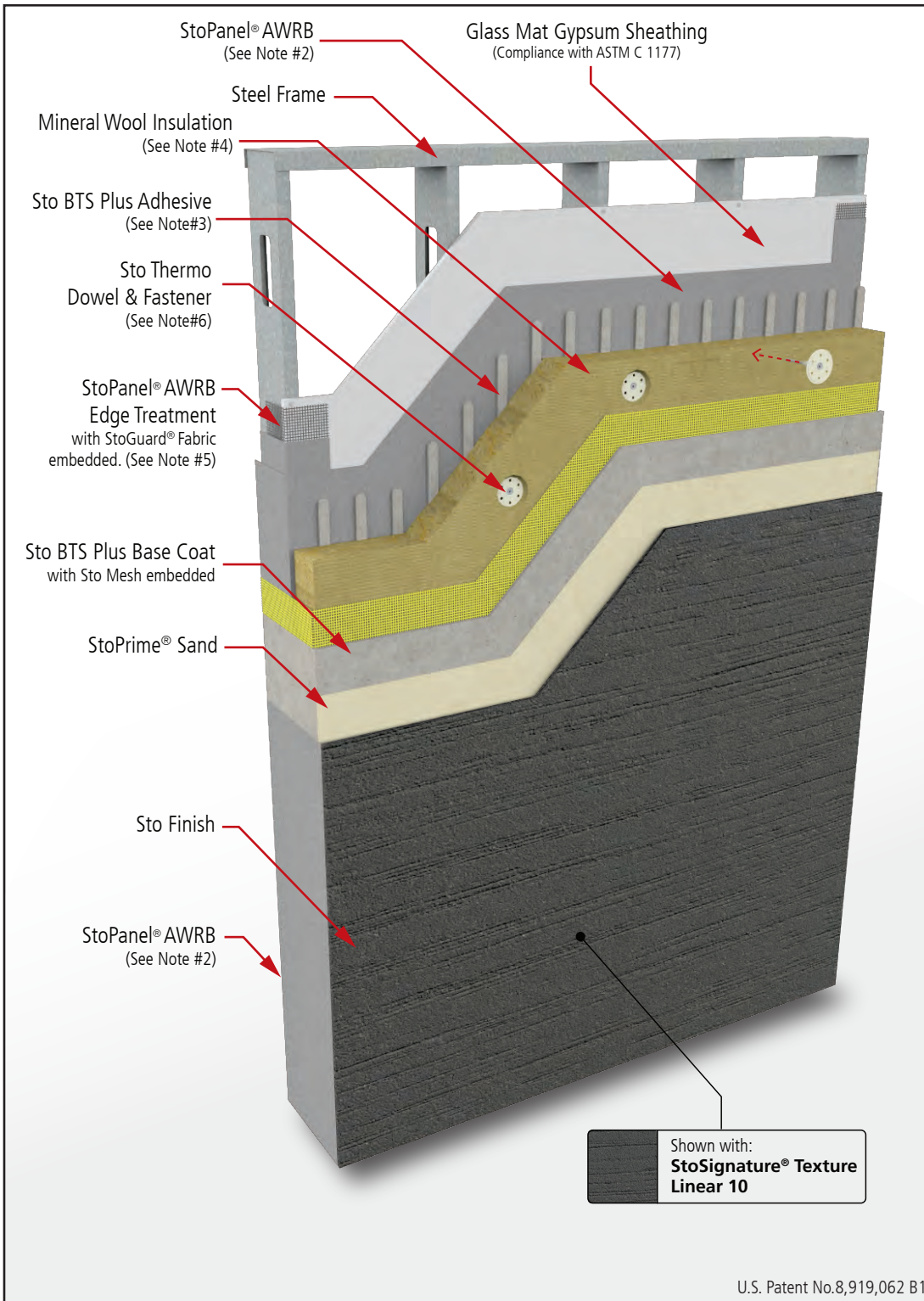

Detail No.: **51.90**  
Date: **October 2023**  
Page: **1 of 3**

### Notes:

1. StoPanel® Mineral ci is a prefabricated exterior wall panel with noncombustible continuous insulation and continuous air and water resistive barrier (AWRB). The panel can be finished with a wide variety of Sto textured finishes, Sto specialty finishes, and StoCast finishes.
2. Alternative air and water resistive barriers (AWRB): Sto Gold Coat®, Sto AirSeal®, and StoGuard® VaporSeal.
3. Vertical ribbons of adhesive to provide channels for drainage.
4. Mineral Wool or Stone Wool Insulation as listed by Sto Corp. Refer to StoPanel® Mineral ci Specification for more information.
5. Alternative Edge and Joint Treatment: Sto RapidGuard®.
6. 2-3/8" inch diameter (60mm) Sto Thermo Dowel with 1/4" (6 mm) corrosion resistant star head type screw fastener. Refer to page 3 for Sto Thermo Cap Wool.
7. Consult with Sto Corp. Technical Dept. for additional information about supplemental fastener rings for increased wind-load performance.
8. Components not identified as Sto are furnished by other manufacturers.

### ATTENTION

Sto products are intended for use by qualified professional contractors, not consumers, as a component of a larger construction assembly as specified by a qualified design professional, general contractor or builder. They should be installed in accordance with those specifications and Sto's instructions. Sto Corp. disclaims all, and assumes no, liability for on-site inspections, for its products applied improperly, or by unqualified persons or entities, or as part of an improperly designed or constructed building, for the nonperformance of adjacent building components or assemblies, or for other construction activities beyond Sto's control. Improper use of Sto products or use as part of an improperly designed or constructed larger assembly or building may result in serious damage to Sto products, and to the structure of the building or its components.

**STO CORP. DISCLAIMS ALL WARRANTIES EXPRESSED OR IMPLIED EXCEPT FOR EXPLICIT LIMITED WRITTEN WARRANTIES ISSUED TO AND ACCEPTED BY BUILDING OWNERS IN ACCORDANCE WITH STO'S WARRANTY PROGRAMS WHICH ARE SUBJECT TO CHANGE FROM TIME TO TIME.** For the fullest, most current information on proper application, clean-up, mixing and other specifications and warranties, cautions and disclaimers, please refer to the Sto Corp. website, [www.stocorp.com](http://www.stocorp.com).

Property of Sto Corp. All Rights Reserved.

[www.stopanel.com](http://www.stopanel.com)



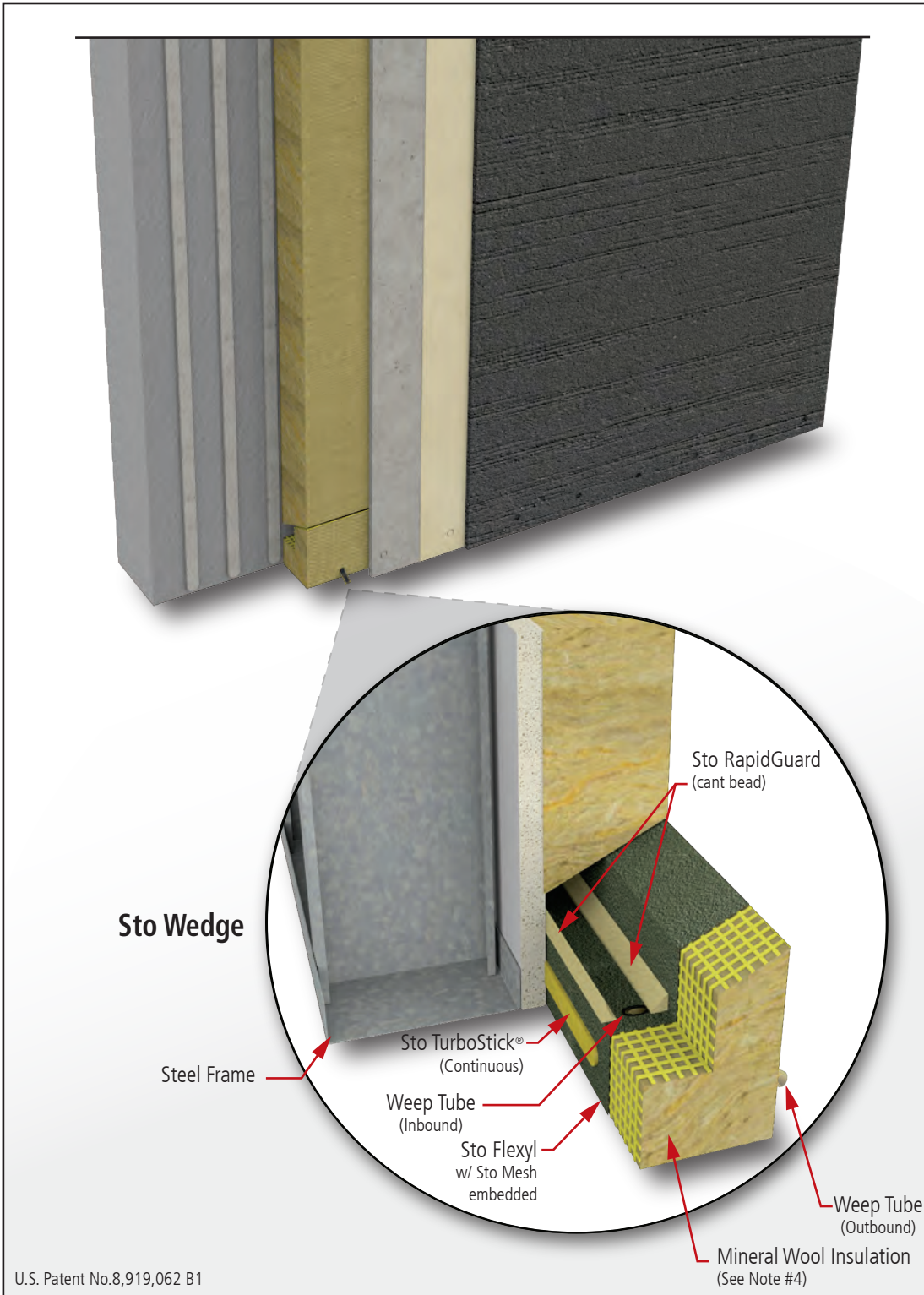

U.S. Patent No.8,919,062 B1

Detail No.: **51.90**  
 Date: **October 2023**  
 Page: **2 of 3**

**Notes:**

1. StoPanel® Mineral ci is a prefabricated exterior wall panel with noncombustible continuous insulation and continuous air and water resistive barrier (AWRB). The panel can be finished with a wide variety of Sto textured finishes, Sto specialty finishes, and StoCast finishes.
2. Alternative air and water resistive barriers (AWRB): Sto Gold Coat®, Sto AirSeal®, and StoGuard® VaporSeal.
3. Vertical ribbons of adhesive to provide channels for drainage.
4. Mineral Wool or Stone Wool Insulation as listed by Sto Corp. Refer to StoPanel® Mineral ci Specification for more information.
5. Alternative Edge and Joint Treatment: Sto RapidGuard®.
6. 2-3/8" inch diameter (60mm) Sto Thermo Dowel with 1/4" (6 mm) corrosion resistant star head type screw fastener. Refer to page 3 for Sto Thermo Cap Wool.
7. Consult with Sto Corp. Technical Dept. for additional information about supplemental fastener rings for increased wind-load performance.
8. Components not identified as Sto are furnished by other manufacturers.

**ATTENTION**

Property of Sto Corp. All Rights Reserved.

Sto products are intended for use by qualified professional contractors, not consumers, as a component of a larger construction assembly as specified by a qualified design professional, general contractor or builder. They should be installed in accordance with those specifications and Sto's instructions. Sto Corp. disclaims all, and assumes no, liability for on-site inspections, for its products applied improperly, or by unqualified persons or entities, or as part of an improperly designed or constructed building, for the nonperformance of adjacent building components or assemblies, or for other construction activities beyond Sto's control. Improper use of Sto products or use as part of an improperly designed or constructed larger assembly or building may result in serious damage to Sto products, and to the structure of the building or its components.

STO CORP. DISCLAIMS ALL WARRANTIES EXPRESSED OR IMPLIED EXCEPT FOR EXPLICIT LIMITED WRITTEN WARRANTIES ISSUED TO AND ACCEPTED BY BUILDING OWNERS IN ACCORDANCE WITH STO'S WARRANTY PROGRAMS WHICH ARE SUBJECT TO CHANGE FROM TIME TO TIME. For the fullest, most current information on proper application, clean-up, mixing and other specifications and warranties, cautions and disclaimers, please refer to the Sto Corp. website, [www.stocorp.com](http://www.stocorp.com).

[www.stopanel.com](http://www.stopanel.com)



## Mechanical Fastening with Sto Thermo Dowel

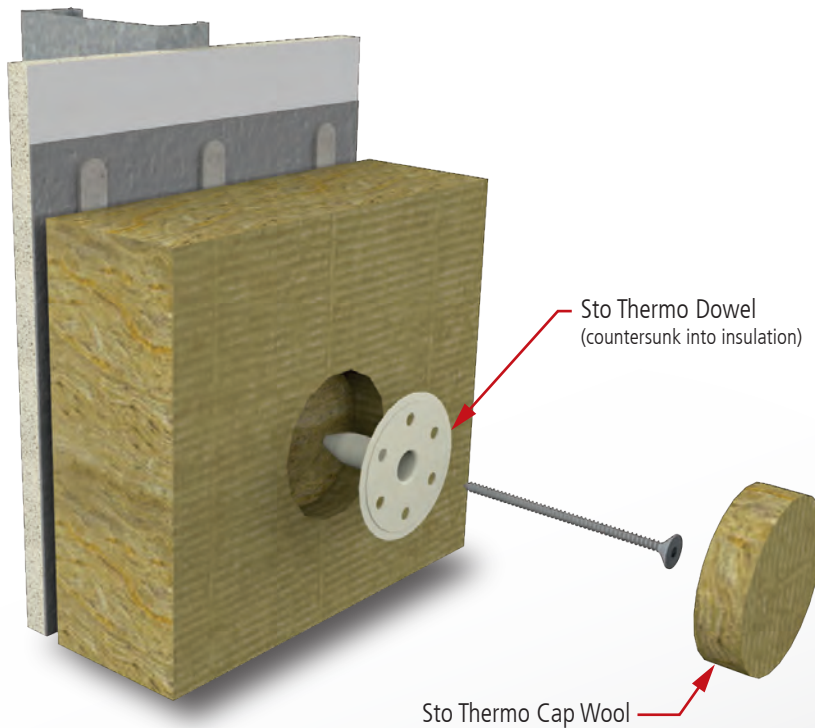

Detail No.: **51.90**

Date: **October 2023**

Page: **3 of 3**

### Notes:

1. StoPanel® Mineral ci is a prefabricated exterior wall panel with noncombustible continuous insulation and continuous air and water resistive barrier (AWRB). The panel can be finished with a wide variety of Sto textured finishes, Sto specialty finishes, and StoCast finishes.
2. Alternative air and water resistive barriers (AWRB): Sto Gold Coat®, Sto AirSeal®, and StoGuard® VaporSeal.
3. Vertical ribbons of adhesive to provide channels for drainage.
4. Mineral Wool or Stone Wool Insulation as listed by Sto Corp. Refer to StoPanel® Mineral ci Specification for more information.
5. Alternative Edge and Joint Treatment: Sto RapidGuard®.
6. 2-3/8" inch diameter (60mm) Sto Thermo Dowel with 1/4" (6 mm) corrosion resistant star head type screw fastener.
7. Consult with Sto Corp. Technical Dept. for additional information about supplemental fastener rings for increased wind-load performance.
8. Components not identified as Sto are furnished by other manufacturers.

### ATTENTION

Property of Sto Corp. All Rights Reserved.

Sto products are intended for use by qualified professional contractors, not consumers, as a component of a larger construction assembly as specified by a qualified design professional, general contractor or builder. They should be installed in accordance with those specifications and Sto's instructions. Sto Corp. disclaims all, and assumes no, liability for on-site inspections, for its products applied improperly, or by unqualified persons or entities, or as part of an improperly designed or constructed building, for the nonperformance of adjacent building components or assemblies, or for other construction activities beyond Sto's control. Improper use of Sto products or use as part of an improperly designed or constructed larger assembly or building may result in serious damage to Sto products, and to the structure of the building or its components.

**STO CORP. DISCLAIMS ALL WARRANTIES EXPRESSED OR IMPLIED EXCEPT FOR EXPLICIT LIMITED WRITTEN WARRANTIES ISSUED TO AND ACCEPTED BY BUILDING OWNERS IN ACCORDANCE WITH STO'S WARRANTY PROGRAMS WHICH ARE SUBJECT TO CHANGE FROM TIME TO TIME.** For the fullest, most current information on proper application, clean-up, mixing and other specifications and warranties, cautions and disclaimers, please refer to the Sto Corp. website, [www.stocorp.com](http://www.stocorp.com).

[www.stopanel.com](http://www.stopanel.com)





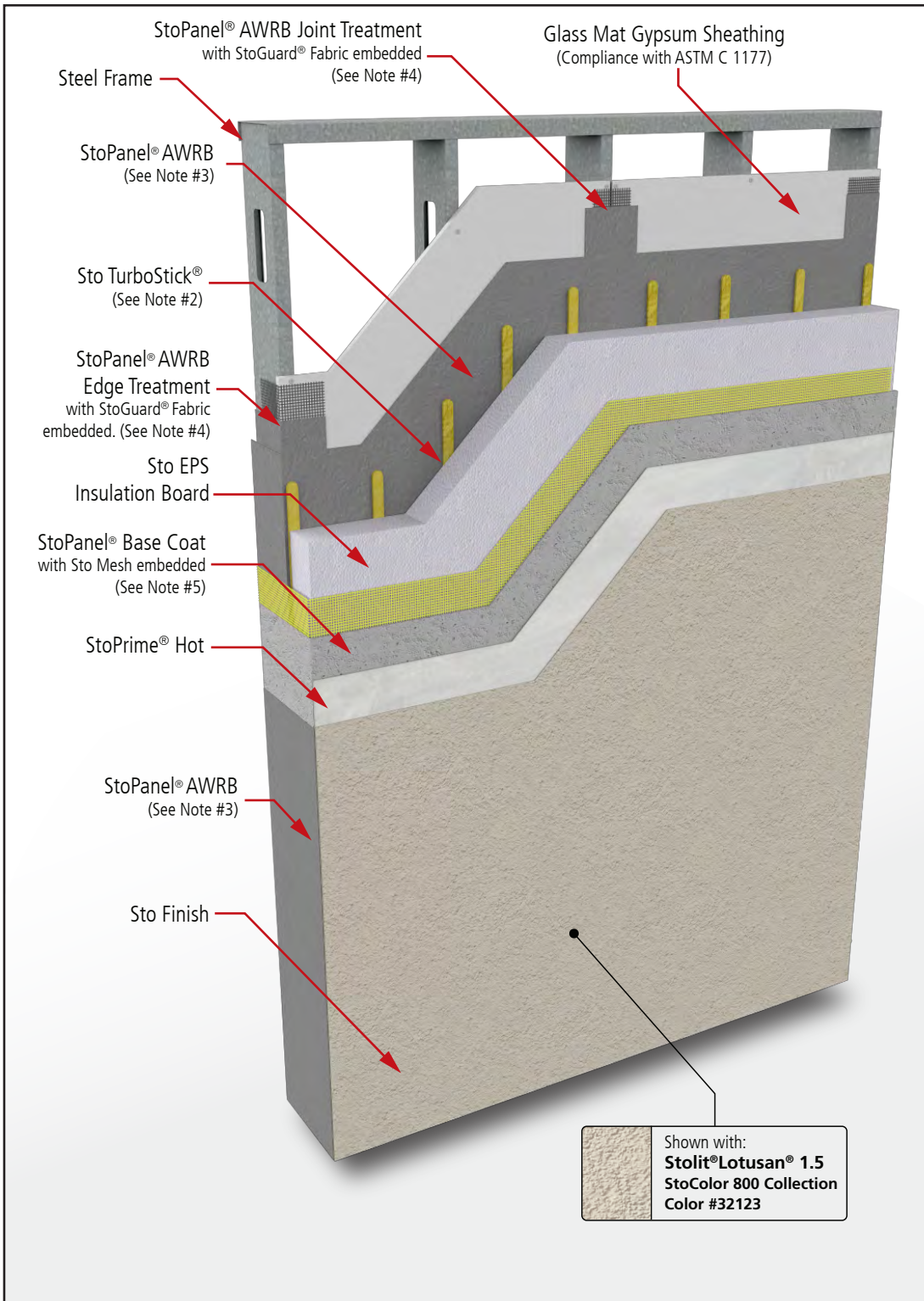

Detail No.: **51.00**  
 Date: **October 2023**  
 Page: **1 of 1**

**Notes:**

1. StoPanel® Classic ci is a lightweight energy efficient pre-fabricated exterior wall panel with continuous air and water-resistive barrier (AWRB). The panel can be finished with a wide variety of Sto textured finishes, Sto specialty finishes, and StoCast finishes.

**IMPORTANT:** StoPanel Classic ci is non-drainable. Refer to project plans, specifications, and local code requirements to verify acceptance.

2. Alternative adhesives: Sto BTS® Plus, Sto Primer/Adhesive-B, Sto Primer/Adhesive (with their prescribed adhesive ribbon spacing).

3. Alternative air and water resistive barriers (AWRB): Sto Gold Coat®, Sto AirSeal®, and StoGuard® VaporSeal (requires Sto TurboStick™ Adhesive)

4. Alternative Edge and Joint Treatment: Sto RapidGuard®.

5. Alternative base coats: Sto BTS® Plus, Sto Primer/Adhesive-B, and Sto Primer/Adhesive (requires Sto textured finish).

6. Components not identified as Sto are furnished by other manufacturers.

**ATTENTION**

Property of Sto Corp. All Rights Reserved.

Sto products are intended for use by qualified professional contractors, not consumers, as a component of a larger construction assembly as specified by a qualified design professional, general contractor or builder. They should be installed in accordance with those specifications and Sto's instructions. Sto Corp. disclaims all, and assumes no, liability for on-site inspections, for its products applied improperly, or by unqualified persons or entities, or as part of an improperly designed or constructed building, for the nonperformance of adjacent building components or assemblies, or for other construction activities beyond Sto's control. Improper use of Sto products or use as part of an improperly designed or constructed larger assembly or building may result in serious damage to Sto products, and to the structure of the building or its components.

**STO CORP. DISCLAIMS ALL WARRANTIES EXPRESSED OR IMPLIED EXCEPT FOR EXPLICIT LIMITED WRITTEN WARRANTIES ISSUED TO AND ACCEPTED BY BUILDING OWNERS IN ACCORDANCE WITH STO'S WARRANTY PROGRAMS WHICH ARE SUBJECT TO CHANGE FROM TIME TO TIME.** For the fullest, most current information on proper application, clean-up, mixing and other specifications and warranties, cautions and disclaimers, please refer to the Sto Corp. website, [www.stocorp.com](http://www.stocorp.com).

[www.stopanel.com](http://www.stopanel.com)



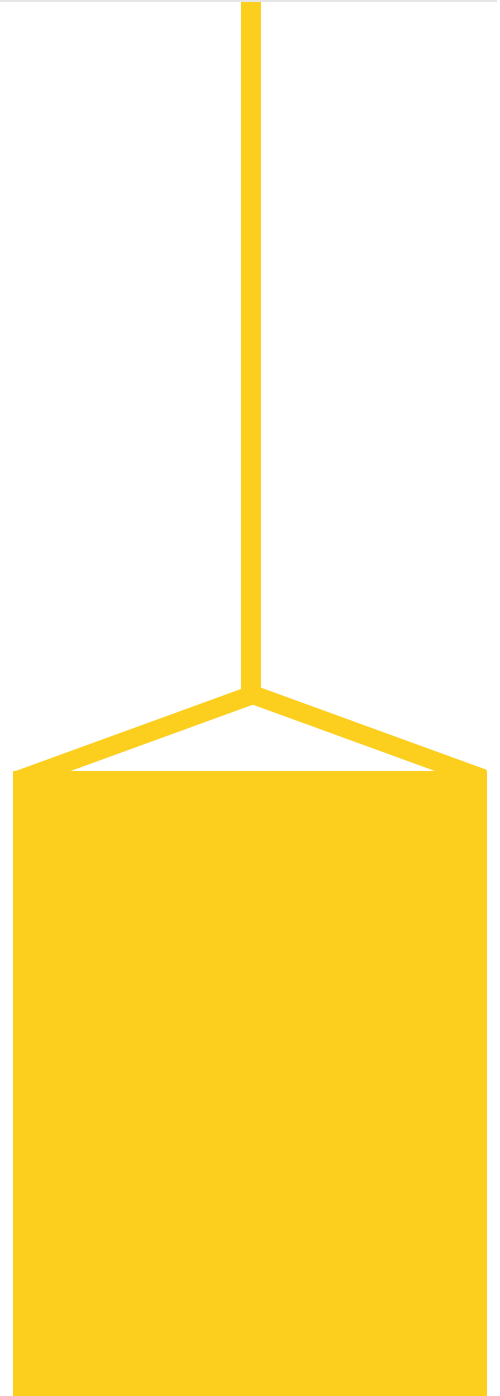

**Sto Americas**

**StoPanel**

3800 Camp Creek Pkwy. SW  
Bldg. 1400 • Suite 120  
Atlanta, GA 30331

Tel: (888) 227-8334 Ext. 40  
Fax: (856) 690-0100  
<http://www.stopanel.com>  
[helpdesk.stocorp.com](mailto:helpdesk.stocorp.com)

**ATTENTION**

Sto products are intended for use by qualified professional contractors, not consumers, as a component of a larger construction assembly as specified by a qualified design professional, general contractor or builder. They should be installed in accordance with those specifications and Sto's instructions. Sto Corp. disclaims all, and assumes no, liability for on-site inspections, for its products applied improperly, or by unqualified persons or entities, or as part of an improperly designed or constructed building, for the nonperformance of adjacent building components or assemblies, of for other construction activities beyond Sto's control. Improper use of Sto products or use as part of an improperly designed or constructed larger assembly or building may result in serious damage to Sto products, and to the structure of the building or its components.

STO CORP. DISCLAIMS ALL WARRANTIES EXPRESSED OR IMPLIED EXCEPT FOR EXPLICIT LIMITED WRITTEN WARRANTIES ISSUED TO AND ACCEPTED BY BUILDING OWNERS IN ACCORDANCE WITH STO'S WARRANTY PROGRAMS WHICH ARE SUBJECT TO CHANGE FROM TIME TO TIME. For the fullest, most current information on proper application, clean-up, mixing and other specifications and warranties, cautions and disclaimers, please refer to the Sto Corp. website, [www.stocorp.com](http://www.stocorp.com).